

# BERWICK WATERS

## HONOUR VILLAGE - STAGE 04 STREETScape

### DRAWING SCHEDULE

310-210-00-L-41-DR100	COVER SHEET/ DRAWINGS SHEDULE / KEYPLAN	1:1000
310-210-00-L-41-DR101	LEGEND / PLANT SCHEDULE	1:500
310-210-00-L-41-DR400	LANDSCAPE PLAN	AS SHOWN
310-210-00-L-41-DR600	STREETSCAPE DETAILS	

KEY PLAN  
SCALE 1:7500

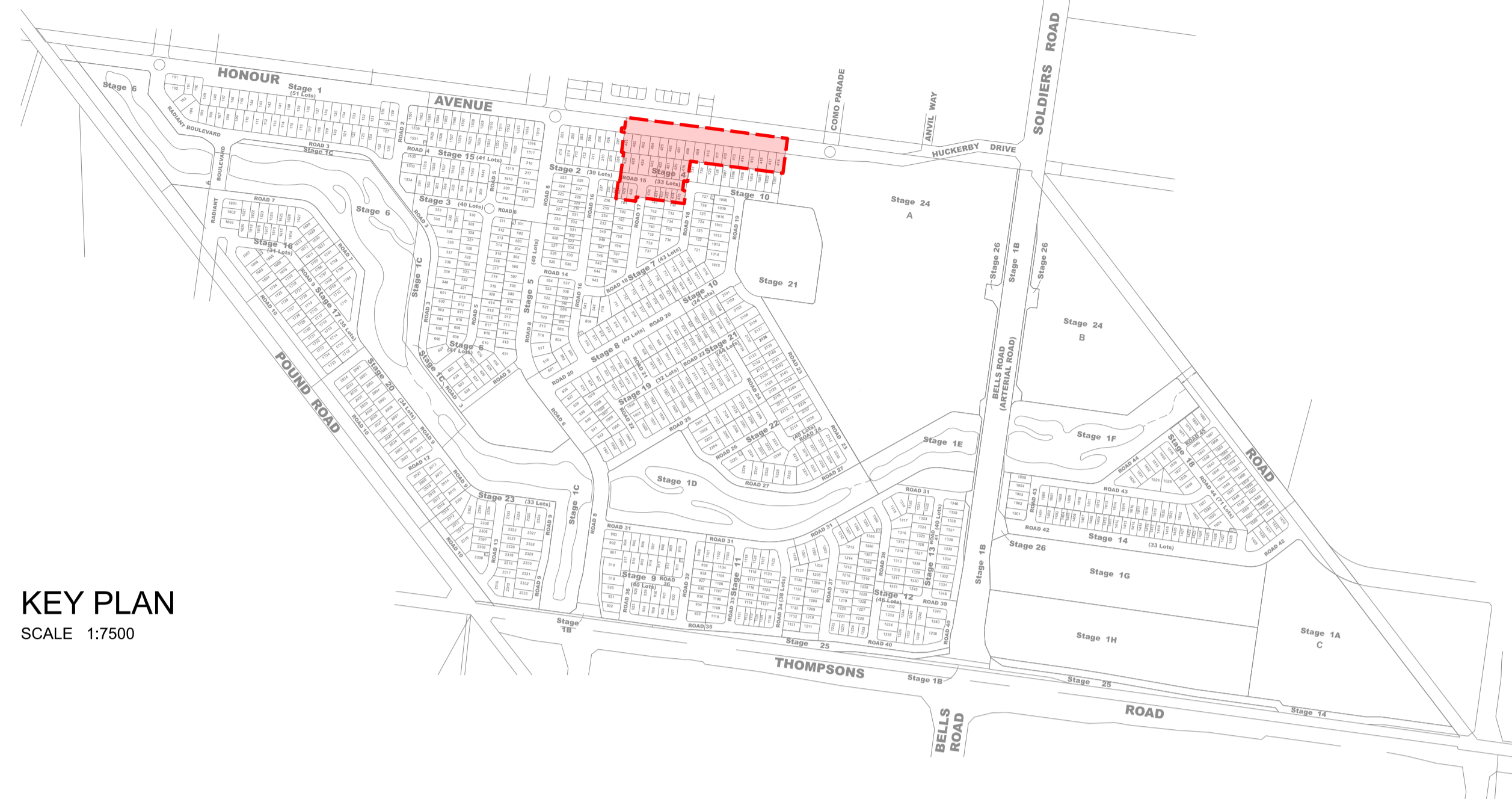

**COMO PARADE**

**GENERAL NOTES**

- DO NOT SCALE DRAWINGS. FIGURED DIMENSIONS HAVE PREFERENCE OVER SCALED DIMENSIONS.
- ANY DISCREPANCIES MUST BE REPORTED IMMEDIATELY TO THE SUPERINTENDENT.
- THESE DRAWINGS ARE TO BE READ IN CONJUNCTION WITH THE DETAILS, SPECIFICATIONS AND ENGINEERING DOCUMENTS.
- LOCATE AND PROTECT ALL UNDERGROUND SERVICES PRIOR TO ANY EXCAVATION. MAKE GOOD ALL DAMAGE TO EXISTING WORKS CAUSED BY THE ACTIVITY OF THESE WORKS.
- THESE DRAWINGS ARE TO BE PRINTED IN COLOUR

These designs, plans and specifications and the copyright therein are the property of TRACT CONSULTANTS PTY. LTD. and must not be used, reproduced or copied, wholly or in part, without the written permission of TRACT CONSULTANTS PTY. LTD.

**TREE PLANTING NOTES:**

THE PLACEMENT OF THE STREET TREES MEETS AUSNET'S 'TREE PLANTING REQUIREMENTS NEAR UNDERGROUND CABLES' AND VESI'S 'URBAN RESIDENTIAL DEVELOPMENT (URD) DESIGN & CONSTRUCTION STANDARD' TO ENSURE THAT TREES DO NOT ENCRoACH ON SERVICES.

STREET TREES ARE TO BE PLANTED NO CLoSER THAN:

- 2.5m FROM HV & LV UNDERGROUND CABLE JOINTS
- 2.5m FROM SPARE OR FUTURE USE CONDUIT ENDS AND SWITCHING CABINETS
- 2.5m FROM SUBSTATIONS
- 1.5m FROM FOOTPATHS
- 1.25m FROM THE BACK OF KERB
- 3.0m FROM DRIVEWAYS
- 4.0m FROM LIGHT POLES AND POWER POLES
- 2.0m FROM SERVICE PITS
- 1.5m ON EITHER SIDE FROM THE SERVICE INDICATOR ON THE FRONT OF THE KERB
- 6.0m FROM INTERSECTIONS
- 2.0m FROM STORMWATER PITS
- 3.0m FROM FIRE PLUGS
- 5.0m FROM COUNCIL RESERVE ADJOINING PROPERTIES

TREES TO BE POSITIONED CENTRALLY WITHIN NATURESTRIPS

CONTRACTOR IS TO NOTIFY SUPERINTENDENT PRIOR TO DELETING ANY TREES DUE TO SERVICE INFRASTRUCTURE LOCATIONS.

FINAL TREE PLACEMENT TO BE DETERMINED ON SITE WITH COUNCIL AT PRE-COMMENCEMENT MEETING.



**CITY OF CASEY  
PARKS & RESERVES  
APPROVED  
DATE: 04/10/2022**

**PRELIMINARY  
NOT FOR CONSTRUCTION**

REV	DESCRIPTION	DATE	DRN	CHKD
1	COUNCIL ISSUE	30.09.22	E.B	J.G
2	COUNCIL ISSUE	04.10.22	E.B	J.G

**Tract  
Landscape Architects  
Urban Designers  
Town Planners**

Melbourne P: 03 9429 6133  
Brisbane P: 07 3002 6400  
Sydney P: 02 9954 3733  
Geelong P: 03 5221 0105  
Adelaide P: 08 8223 1324

www.tract.com.au

**PROJECT**  
BERWICK WATERS  
HONOUR VILLAGE

**CLIENT**  
FRASERS PROPERTY AUSTRALIA

**DRAWING TITLE**  
STAGE 4 STREETScape  
COVER SHEET  
DRAWING SCHEDULE / KEY PLAN

**DRAWING NUMBER** 310-0210-00-L-41-DR100  
**REVISION** 2

**DRAWN** P.C  
**CHECKED** E.B  
**APPROVED** J.G  
**DATE** 02.06.2022

**SCALE** 1:1000  
A1

A

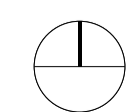

# LEGEND

## GENERAL

--- LIMIT OF WORKS

PROPOSED TREES TO ADJOINING STAGES SHOWN AS INDICATIVE ONLY REFER TO EACH PACKAGE FOR FURTHER DETAIL

EXISTING NEIGHBOURING PATH NETWORK

----- FUTURE NEIGHBOURING PATH NETWORK

## SOFTWORKS

**G1** - INSTANT TURF  
REFER TO DETAIL  
(ALL GRASSED AREAS TO HAVE A MAX GRADE OF 1:6)

2  
600

**G2** - HYDROSEEDING TURF  
REFER TO DETAIL  
(ALL GRASSED AREAS TO HAVE A MAX GRADE OF 1:6)

3  
600

## STREET TREE PLANTING

100 LITRE



45 LITRE

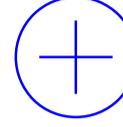

ANGOPHORA COSTATA

Smooth-barked Apple

QUERCUS PALUSTRIS

Pin Oak

ULMUS CARPINIFOLIA x PARVIFLORA 'FRONTIER'

Frontier Elm

ZELKOVA SERRATA 'GREEN VASE'

Japanese Zelkova

1  
600

# PLANTING SCHEDULE

CODE	BOTANIC NAME	COMMON NAME	NATVE/EXOTIC	MATURE SIZE (H x W)	DENSITY	INSTALL SIZE	QTY
<b>TREES - 100 LITRE</b>							
	<i>Angophora costata</i>	Smooth-barked Apple	Indigenous	20 x 15m	as shown	75Lt / 32.5-3.0m (H) / 35-40mm Cal	24
	<i>Quercus palustris</i>	Pin Oak	Exotic	15 x 8m	as shown	200Lt / 3.2-3.5m (H) / 30mm Cal	42
						<b>Total</b>	<b>66</b>
<b>TREES - 45 LITRE</b>							
	<i>Ulmus carpinifolia x parviflora 'Frontier'</i>	Frontier Elm	Exotic	12 x 9m	as shown	45Lt / 2m (H) / 30mm Cal	12
	<i>Zelkova serrata 'Green Vase'</i>	Japanese Zelkova	Exotic	20 x 15m	as shown	45Lt / 2m (H) / 30mm Cal	4
						<b>Total</b>	<b>16</b>

## GENERAL NOTES

- DO NOT SCALE DRAWINGS. FIGURED DIMENSIONS HAVE PREFERENCE OVER SCALED DIMENSIONS.
- ANY DISCREPANCIES MUST BE REPORTED IMMEDIATELY TO THE SUPERINTENDENT.
- THESE DRAWINGS ARE TO BE READ IN CONJUNCTION WITH THE DETAILS, SPECIFICATIONS AND ENGINEERING DOCUMENTS.
- LOCATE AND PROTECT ALL UNDERGROUND SERVICES PRIOR TO ANY EXCAVATION. MAKE GOOD ALL DAMAGE TO EXISTING WORKS CAUSED BY THE ACTIVITY OF THESE WORKS.
- THESE DRAWINGS ARE TO BE PRINTED IN COLOUR

These designs, plans and specifications and the copyright therein are the property of TRACT CONSULTANTS PTY. LTD. and must not be used, reproduced or copied, wholly or in part, without the written permission of TRACT CONSULTANTS PTY. LTD.

## TREE PLANTING NOTES:

THE PLACEMENT OF THE STREET TREES MEETS AUSNET'S 'TREE PLANTING REQUIREMENTS NEAR UNDERGROUND CABLES' AND VEST'S 'URBAN RESIDENTIAL DEVELOPMENT (URD) DESIGN & CONSTRUCTION STANDARD' TO ENSURE THAT TREES DO NOT ENCRoACH ON SERVICES.

STREET TREES ARE TO BE PLANTED NO CLOSER THAN:

- 2.5m FROM HV & LV UNDERGROUND CABLE JOINTS
- 2.5m FROM SPARE OR FUTURE USE CONDUIT ENDS
- 2.5m FROM PARALLEL OR DISTRIBUTION PILLARS AND SWITCHING CABINETS
- 2.5m FROM SUBSTATIONS
- 1.5m FROM FOOTPATHS
- 1.25m FROM THE BACK OF KERB
- 3.0m FROM DRIVEWAYS
- 4.0m FROM LIGHT POLES AND POWER POLES
- 2.0m FROM SERVICE PITS
- 1.5m ON EITHER SIDE FROM THE SERVICE INDICATOR ON THE FRONT OF THE KERB
- 6.0m FROM INTERSECTIONS
- 2.0m FROM STORMWATER PITS
- 3.0m FROM FIRE PLUGS
- 5.0m FROM COUNCIL RESERVE ADJOINING PROPERTIES

TREES TO BE BEHIND SPLAY FOR CORNER BLOCKS.

TREES TO BE POSITIONED CENTRALLY WITHIN NATURESTRIPS

CONTRACTOR IS TO NOTIFY SUPERINTENDENT PRIOR TO DELETING ANY TREES DUE TO SERVICE INFRASTRUCTURE LOCATIONS.

FINAL TREE PLACEMENT TO BE DETERMINED ON SITE WITH COUNCIL AT PRE-COMMENCEMENT MEETING.



CITY OF CASEY  
PARKS & RESERVES  
**APPROVED**  
DATE: 04/10/2022

## PRELIMINARY NOT FOR CONSTRUCTION

REV	DESCRIPTION	DATE	DRN	CHKD
1	COUNCIL ISSUE	30.09.22	E.B	J.G
2	COUNCIL ISSUE	04.10.22	E.B	J.G

**Tract**  
Landscape Architects  
Urban Designers  
Town Planners

Melbourne P: 03 9429 6133  
Brisbane P: 07 3002 6400  
Sydney P: 02 9954 3733  
Geelong P: 03 5221 0105  
Adelaide P: 08 8223 1324 [www.tract.com.au](http://www.tract.com.au)

## PROJECT

BERWICK WATERS  
HONOUR VILLAGE

## CLIENT

FRASERS PROPERTY AUSTRALIA

## DRAWING TITLE

STAGE 4 STREETScape  
LEGEND  
PLANT SCHEDULE

## DRAWING NUMBER REVISION

310-0210-00-L-41-DR101 2

## DRAWN CHECKED APPROVED DATE

P.C E.B J.G 02.06.2022

## SCALE

A1

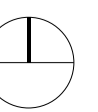



- GENERAL NOTES**
- DO NOT SCALE DRAWINGS. FIGURED DIMENSIONS HAVE PREFERENCE OVER SCALED DIMENSIONS.
  - ANY DISCREPANCIES MUST BE REPORTED IMMEDIATELY TO THE SUPERINTENDENT.
  - THESE DRAWINGS ARE TO BE READ IN CONJUNCTION WITH THE DETAILS, SPECIFICATIONS AND ENGINEERING DOCUMENTS.
  - LOCATE AND PROTECT ALL UNDERGROUND SERVICES PRIOR TO ANY EXCAVATION. MAKE GOOD ALL DAMAGE TO EXISTING WORKS CAUSED BY THE ACTIVITY OF THESE WORKS.
  - THESE DRAWINGS ARE TO BE PRINTED IN COLOUR

These designs, plans and specifications and the copyright therein are the property of TRACT CONSULTANTS PTY. LTD. and must not be used, reproduced or copied, wholly or in part, without the written permission of TRACT CONSULTANTS PTY. LTD.

- TREE PLANTING NOTES:**
- THE PLACEMENT OF THE STREET TREES MEETS AUSNET'S 'TREE PLANTING REQUIREMENTS NEAR UNDERGROUND CABLES' AND VEST'S 'URBAN RESIDENTIAL DEVELOPMENT (URD) DESIGN & CONSTRUCTION STANDARD' TO ENSURE THAT TREES DO NOT ENCROUGH ON SERVICES.

- STREET TREES ARE TO BE PLANTED NO CLOSER THAN:
- 2.5m FROM HV & LV UNDERGROUND CABLE JOINTS
  - 2.5m FROM SPARE OR FUTURE USE CONDUIT ENDS
  - 2.5m FROM PARALLEL OR DISTRIBUTION PILLARS AND SWITCHING CABINETS
  - 2.5m FROM SUBSTATIONS
  - 1.5m FROM FOOTPATHS
  - 1.25m FROM THE BACK OF KERB
  - 3.0m FROM DRIVEWAYS
  - 4.0m FROM LIGHT POLES AND POWER POLES
  - 2.0m FROM SERVICE PITS
  - 1.5m ON EITHER SIDE FROM THE SERVICE INDICATOR ON THE FRONT OF THE KERB
  - 6.0m FROM INTERSECTIONS
  - 2.0m FROM STORMWATER PITS
  - 3.0m FROM FIRE PLUGS
  - 5.0m FROM COUNCIL RESERVE ADJOINING PROPERTIES

TREES TO BE BEHIND SPLAY FOR CORNER BLOCKS.

TREES TO BE POSITIONED CENTRALLY WITHIN NATURESTRIPS

CONTRACTOR IS TO NOTIFY SUPERINTENDENT PRIOR TO DELETING ANY TREES DUE TO SERVICE INFRASTRUCTURE LOCATIONS.

FINAL TREE PLACEMENT TO BE DETERMINED ON SITE WITH COUNCIL AT PRE-COMMENCEMENT MEETING.



**CITY OF CASEY  
PARKS & RESERVES  
APPROVED  
DATE: 04/10/2022**

**PRELIMINARY  
NOT FOR CONSTRUCTION**

REV	DESCRIPTION	DATE	DRN	CHKD
1	COUNCIL ISSUE	30.09.22	E.B	J.G
2	COUNCIL ISSUE	04.10.22	E.B	J.G

**Tract  
Landscape Architects  
Urban Designers  
Town Planners**

Melbourne P: 03 9429 6133  
Brisbane P: 07 3002 6400  
Sydney P: 02 9954 3733  
Geelong P: 03 5221 0105  
Adelaide P: 08 8223 1324 [www.tract.com.au](http://www.tract.com.au)

**PROJECT**  
BERWICK WATERS  
HONOUR VILLAGE

**CLIENT**  
FRASERS PROPERTY AUSTRALIA

**DRAWING TITLE**  
STAGE 4 STREETSCAPE  
LANDSCAPE PLAN

**DRAWING NUMBER** 310-0210-00-L-41-DR400  
**REVISION** 2

**DRAWN** P.C **CHECKED** E.B **APPROVED** J.G **DATE** 02.06.2022

**SCALE** 1:500 **A1**

UNENCUMBERED  
PUBLIC OPEN  
SPACE "C" (NP6)

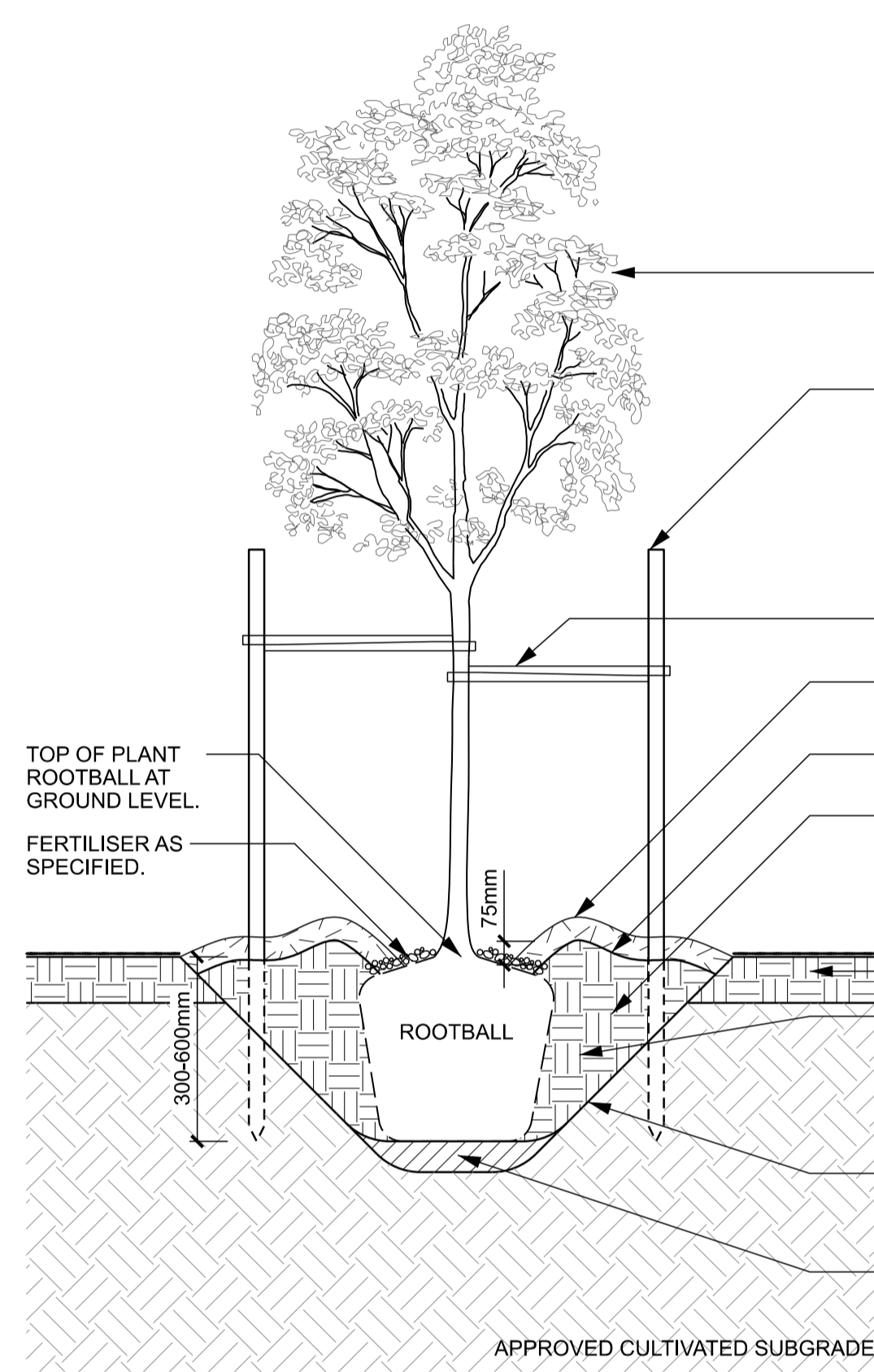
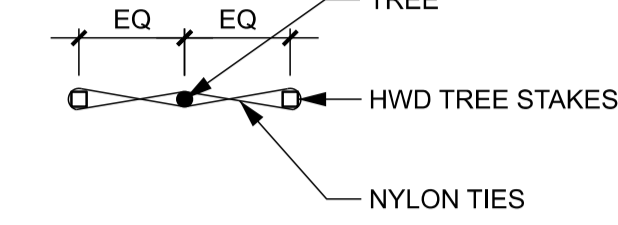
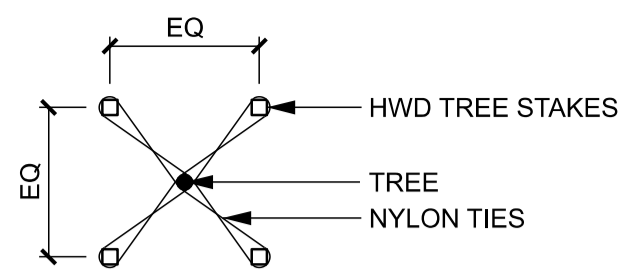

**1** ADVANCED TREE TYPICAL PLANTING DETAIL 1:20

**TREE STAKES:**

SIZE	No:	Stakes Size (min)
a) 200L	4	75 x 75 x 2400mm
b) 100L	3	75 x 75 x 2400mm
c) 75L	3	75 x 75 x 2400mm
d) 45L	3	75 x 75 x 1800mm
e) 35L	3	75 x 75 x 1800mm

**NOTES:**

- TREES SHALL HAVE A WELL-DEVELOPED TAPER AND BE SELF-SUPPORTING IN BOTH ROOTBALL AND TRUNK.
- EACH TREE MUST DEMONSTRATE A SINGLE CENTRAL LEADER WITH A GOOD BRANCH STRUCTURE THROUGHOUT.
- ALL TREES MUST DEMONSTRATE GOOD HEALTH AND VIGOR WITH NO PEST OR DISEASE PRESENT.
- TREES SHALL SHOW NO SYMPTOMS OF STRESS OR DAMAGE.
- PLANTING HOLE TO BE WATERED PRIOR TO SETTING OF TREES, WATER TREE THOROUGHLY BEFORE AND IMMEDIATELY AFTER PLANTING.
- IT IS THE RESPONSIBILITY OF THE CONTRACTOR TO CONFIRM THE LOCATION OF ALL UNDERGROUND SERVICES PRIOR TO COMMENCEMENT OR ANY EXCAVATION OR STAKING WORKS.
- SITE TO BE LEFT CLEAN AND TIDY ON COMPLETION OF PLANTING. REMOVE WEEDS AND BUILDING SPOIL FROM PLANTING ZONE.
- IMPORTED SOILS MUST COMPLY WITH THE LATEST VERSION OF AS 4419 - SOILS FOR LANDSCAPING AND GARDEN USE

**2** INSTANT TURF TYPICAL DETAIL 1:10

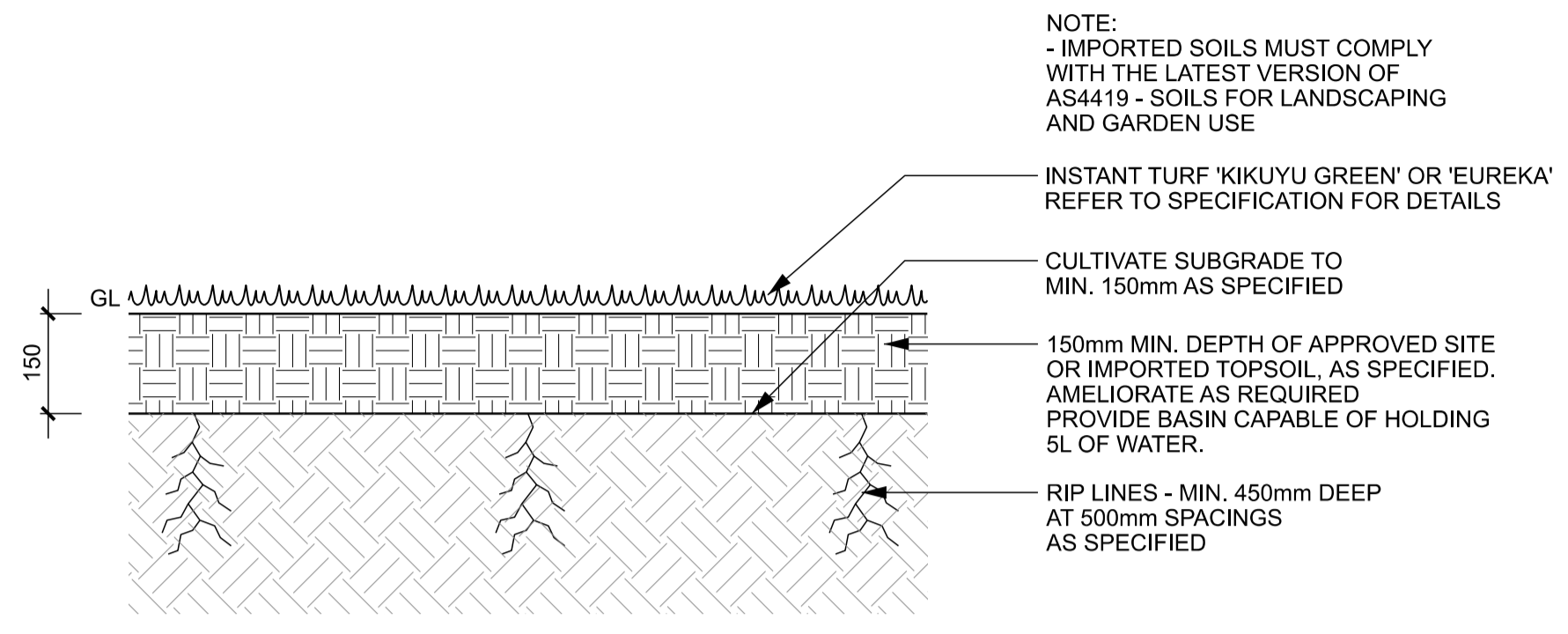

**3** HYDROSEEDING TURF TYPICAL DETAIL 1:10

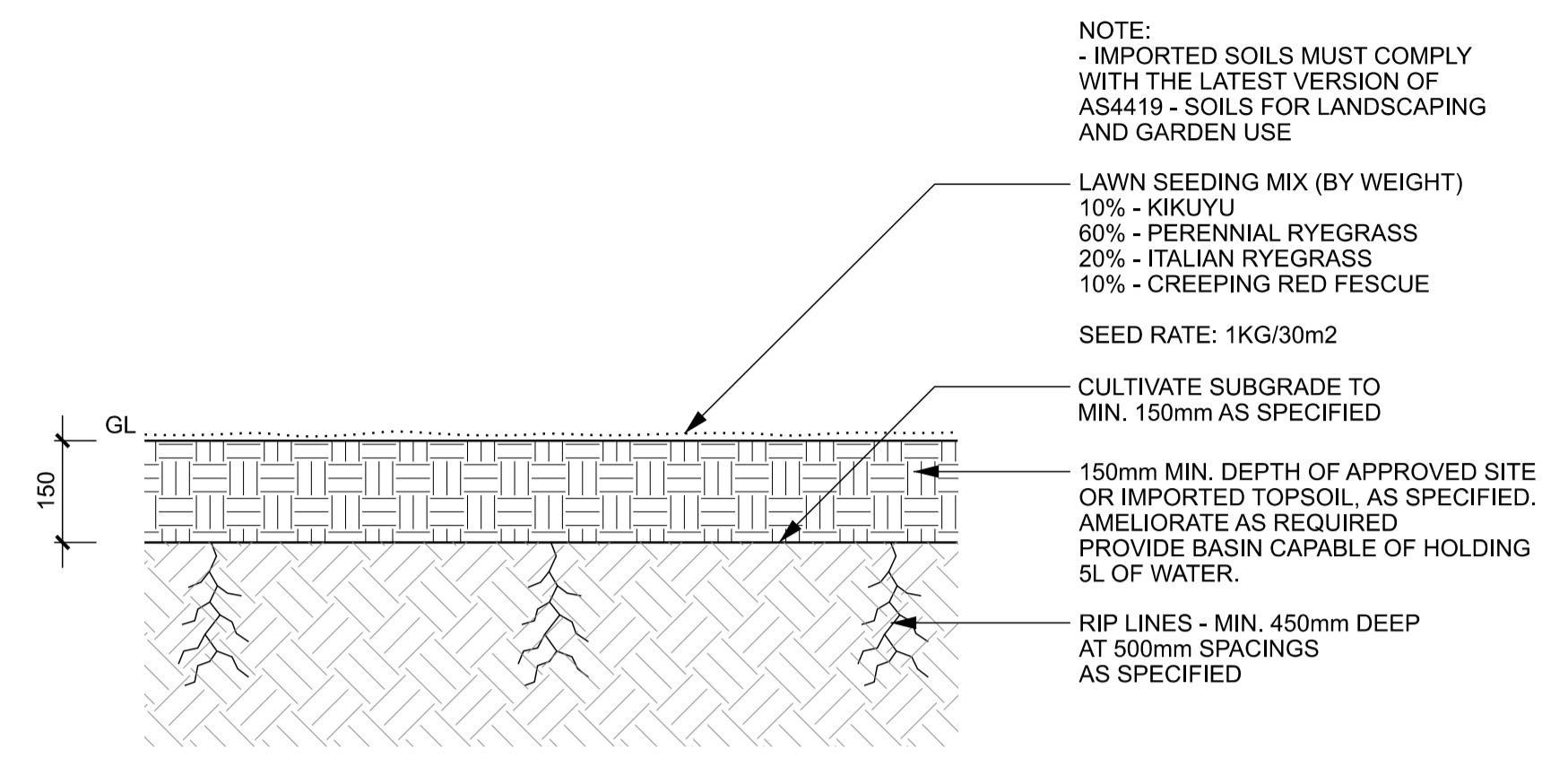

**NOTE:**

- IMPORTED SOILS MUST COMPLY WITH THE LATEST VERSION OF AS4419 - SOILS FOR LANDSCAPING AND GARDEN USE

**GENERAL NOTES**

- DO NOT SCALE DRAWINGS. FIGURED DIMENSIONS HAVE PREFERENCE OVER SCALED DIMENSIONS.
- ANY DISCREPANCIES MUST BE REPORTED IMMEDIATELY TO THE SUPERINTENDENT.
- THESE DRAWINGS ARE TO BE READ IN CONJUNCTION WITH THE DETAILS, SPECIFICATIONS AND ENGINEERING DOCUMENTS.
- LOCATE AND PROTECT ALL UNDERGROUND SERVICES PRIOR TO ANY EXCAVATION. MAKE GOOD ALL DAMAGE TO EXISTING WORKS CAUSED BY THE ACTIVITY OF THESE WORKS.
- THESE DRAWINGS ARE TO BE PRINTED IN COLOUR

These designs, plans and specifications and the copyright therein are the property of TRACT CONSULTANTS PTY. LTD. and must not be used, reproduced or copied, wholly or in part, without the written permission of TRACT CONSULTANTS PTY. LTD.

**TREE PLANTING NOTES:**

THE PLACEMENT OF THE STREET TREES MEETS AUSNET'S 'TREE PLANTING REQUIREMENTS NEAR UNDERGROUND CABLES' AND VESTI'S 'URBAN RESIDENTIAL DEVELOPMENT (URD) DESIGN & CONSTRUCTION STANDARD' TO ENSURE THAT TREES DO NOT ENCRUCH ON SERVICES.

STREET TREES ARE TO BE PLANTED NO CLOSER THAN:

- 2.5m FROM HV & LV UNDERGROUND CABLE JOINTS
- 2.5m FROM SPARE OR FUTURE USE CONDUIT ENDS
- 2.5m FROM PARALLEL OR DISTRIBUTION PILLARS AND SWITCHING CABINETS
- 2.5m FROM SUBSTATIONS
- 1.5m FROM FOOTPATHS
- 1.25m FROM THE BACK OF KERB
- 3.0m FROM DRIVEWAYS
- 4.0m FROM LIGHT POLES AND POWER POLES
- 2.0m FROM SERVICE PITS
- 1.5m ON EITHER SIDE FROM THE SERVICE INDICATOR ON THE FRONT OF THE KERB
- 6.0m FROM INTERSECTIONS
- 2.0m FROM STORMWATER PITS
- 3.0m FROM FIRE PLUGS
- 5.0m FROM COUNCIL RESERVE ADJOINING PROPERTIES

TREES TO BE BEHIND SPLAY FOR CORNER BLOCKS.

TREES TO BE POSITIONED CENTRALLY WITHIN NATURESTRIPS

CONTRACTOR IS TO NOTIFY SUPERINTENDENT PRIOR TO DELETING ANY TREES DUE TO SERVICE INFRASTRUCTURE LOCATIONS.

FINAL TREE PLACEMENT TO BE DETERMINED ON SITE WITH COUNCIL AT PRE-COMMENCEMENT MEETING.



**CITY OF CASEY  
PARKS & RESERVES  
APPROVED  
DATE: 04/10/2022**

**PRELIMINARY  
NOT FOR CONSTRUCTION**

REV	DESCRIPTION	DATE	DRN	CHKD
1	COUNCIL ISSUE	30.09.22	E.B	J.G
2	COUNCIL ISSUE	04.10.22	E.B	J.G

**Tract  
Landscape Architects  
Urban Designers  
Town Planners**

Melbourne P: 03 9429 6133  
Brisbane P: 07 3002 6400  
Sydney P: 02 9954 3733  
Geelong P: 03 5221 0105  
Adelaide P: 08 8223 1324 [www.tract.com.au](http://www.tract.com.au)

**PROJECT**

BERWICK WATERS  
HONOUR VILLAGE

**CLIENT**

FRASERS PROPERTY AUSTRALIA

**DRAWING TITLE**

STAGE 4 STREETScape  
DETAILS

**DRAWING NUMBER** 310-0210-00-L-41-DR600

**REVISION** 2

**DRAWN** P.C **CHECKED** E.B **APPROVED** J.G **DATE** 02.06.2022

**SCALE**  
AS SHOWN A1

