

LEGEND - LAYOUT PLAN

- STORMWATER DRAIN, PIT & PROPERTY INLET
- MELBOURNE WATER DRAIN & PIT
- SWALE DRAIN
- SEWER & MAINTENANCE STRUCTURES
- HOUSE DRAIN
- SERVICE CONDUITS
- TACTILE PAVERS (INDICATIVE ONLY)
- ELECTRICITY (UNDERGROUND)
- ELECTRICITY (OVERHEAD)
- OPTIC FIBRE
- TELECOMMUNICATIONS
- GAS
- WATER
- RECYCLED WATER
- EXISTING ELECTRICITY (UNDERGROUND)
- EXISTING ELECTRICITY (OVERHEAD)
- EXISTING GAS
- EXISTING OPTIC FIBRE
- EXISTING TELECOMMUNICATIONS
- EXISTING WATER
- EXISTING RECYCLED WATER
- EXISTING STORMWATER DRAIN
- EXISTING SEWER
- EXISTING HOUSE DRAIN
- EXISTING SWALE DRAIN
- EXISTING SURFACE LEVEL
- FINISHED BUILDING LINE LEVEL
- FINISHED RIDGE LINE LEVEL
- TOP OF RETAINING WALL
- BOTTOM OF RETAINING WALL
- RIDGE LINE
- RETAINING WALL
- ZERO LOT LINES
- PAVEMENT TREATMENT
- STRUCTURAL FILL > 200mm DEEP
- EX. STRUCTURAL FILL > 200mm DEEP
- DIRECTION OF FALL
- OVERLAND FLOW
- STRUCTURAL EARTHWORKS REQUIRED AND ALLOTMENT TO BE GRADED EVENLY IN DIRECTION OF FALL TO LEVELS INDICATED
- CONCRETE EDGE STRIP WITH SUBSOIL DRAIN, 'NO ROAD' SIGN & BARRIER
- LIMIT OF WORKS
- EXISTING TREE TO BE REMOVED
- PERMANENT SURVEY MARK
- TEMPORARY BENCH MARK
- PROPOSED DRIVEWAY
- TREE PROTECTION ZONE (TPZ)

- NOTES:**
- These plans are preliminary only and have not been approved by Council. They are subject to change without notice and have been provided as a guide only.
 - This plan must be read in conjunction with the plan of subdivision. If any discrepancies are identified between the two plans, the plan of subdivision takes precedence.
 - Proposed services and connection points shown are preliminary only and subject to authority advice and approval. Vehicle crossing locations shown are subject to Council approval.
 - Existing surface levels refer to the existing surface surveyed by Beveridge Williams & Co Pty Ltd.
 - Finished surface levels shown are preliminary only and may be subject to change during design and/or construction.
 - The depth of fill can be determined by calculating the depth between the existing and proposed finished surface levels.
 - Fill depths do not take into account any removal of topsoil, grubbing, or excavation associated with the construction of any temporary or permanent infrastructure within the subdivision.
 - The plan shows the indicative extent of fill greater than 200mm in depth. These extents may be subject to change during design and/or construction. Fill less than 200mm in depth is not shown on this plan.
 - The fill depth shown on this plan is for fill placed during construction of the subdivision whilst the site is under the control of Beveridge Williams & Co Pty Ltd. Beveridge Williams & Co Pty Ltd has no further knowledge or records of any other filling works throughout this subdivision, including prior to the survey being undertaken, or after the completion of construction.
 - Beveridge Williams & Co Pty Ltd will not be liable for any loss or damages incurred or suffered by any party due to the use of the plans or relying on the information contained within these plans.

WARNING
BWARE OF UNDERGROUND SERVICES
 The locations of underground services are approximate only and their exact position should be proven on site.
 No guarantee is given that all existing services are shown.
 Locate all underground services before commencement of works.
DIAL 1100 BEFORE YOU DIG
 www.1100.com.au

PRELIMINARY PRINT
NOT FOR CONSTRUCTION

© COPYRIGHT All rights reserved Beveridge Williams & Co. Pty Ltd has granted a licence to the principle to use this document for its intended purpose. No unauthorised copying is permitted.					
PS	LEGEND - LAYOUT PLAN NOTES REVISED	07.09.21	N.T.	S.K.	
P4	LOT 222 DRIVEWAY MOVED TO THE EAST BL	23.06.21	S.K.	S.K.	
P3	SEWER LAYOUT AND EASEMENTS AMENDED	29.04.21	S.G.	S.K.	
P2	FS & FR LEVEL CHANGES	20.10.20	S.G.	S.K.	
P1	ISSUED FOR INFORMATION	21.09.20	M.F.J.	S.K.	
REV	DESCRIPTION	DATE	DRN.	APP.	REV

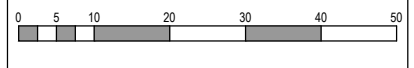

Designed Date: C. YAP 21.09.20
 Drawn: M.F. JAURIGUE
 Approved Date: S. KONG 21.09.20
 PS Number: -



Project Details: FIVE FARMS STAGE 2 CITY OF CASEY
 Drawing Title: SALES PLAN (SHEET 1 OF 2)

Sheet 01 of 02
 Scale: 1:500 @ A1
 Project Ref: 1702037 Stage No: 02 Drawing No: 990 Rev: P5

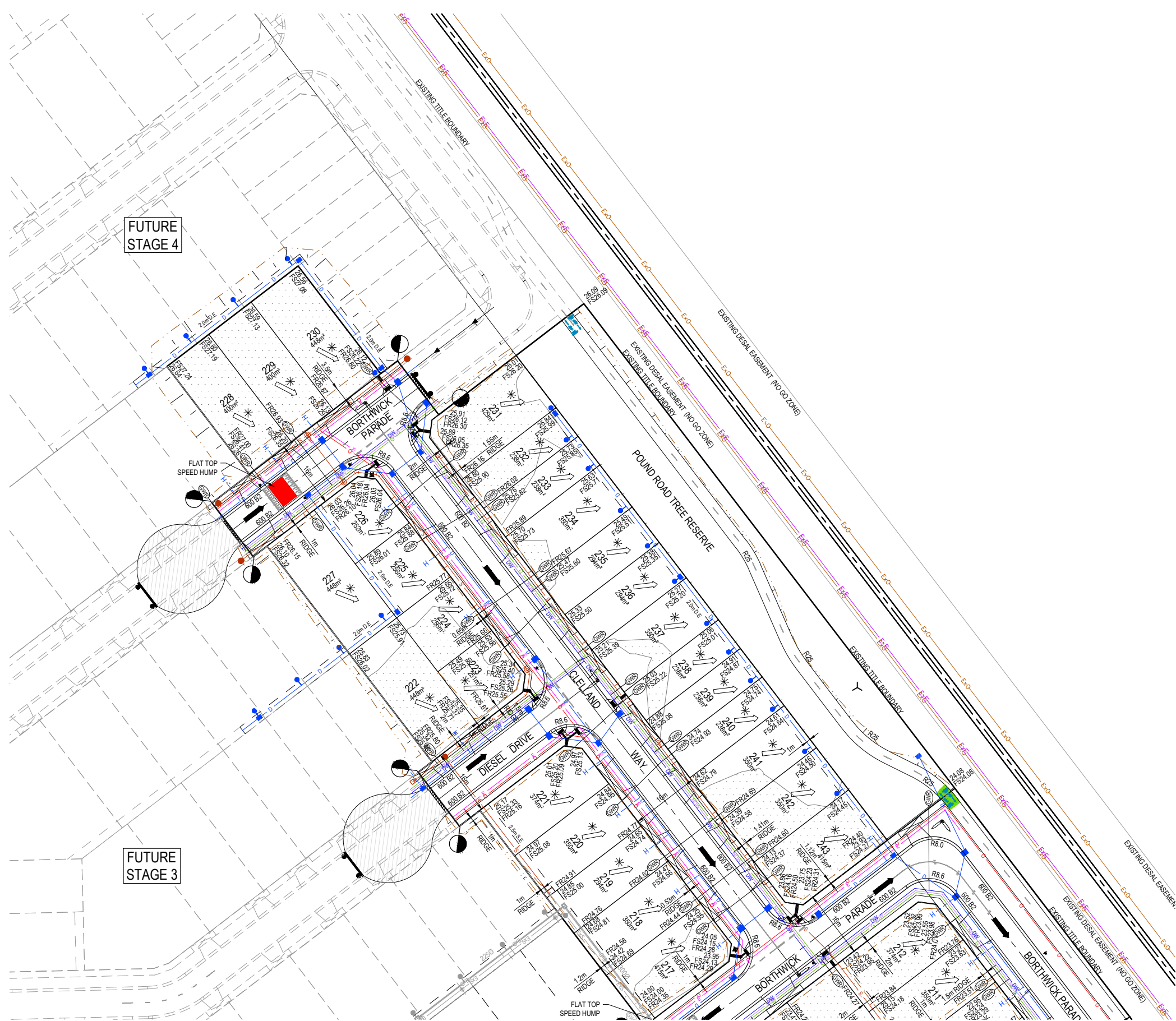

LEGEND - LAYOUT PLAN

- STORMWATER DRAIN, PIT & PROPERTY INLET
- MELBOURNE WATER DRAIN & PIT
- SWALE DRAIN
- SEWER & MAINTENANCE STRUCTURES
- HOUSE DRAIN
- SERVICE CONDUITS
- TACTILE PAVERS (INDICATIVE ONLY)
- ELECTRICITY (UNDERGROUND)
- ELECTRICITY (OVERHEAD)
- OPTIC FIBRE
- TELECOMMUNICATIONS
- GAS
- WATER
- RECYCLED WATER
- EXISTING ELECTRICITY (UNDERGROUND)
- EXISTING ELECTRICITY (OVERHEAD)
- EXISTING GAS
- EXISTING OPTIC FIBRE
- EXISTING TELECOMMUNICATIONS
- EXISTING WATER
- EXISTING RECYCLED WATER
- EXISTING STORMWATER DRAIN
- EXISTING SEWER
- EXISTING HOUSE DRAIN
- EXISTING SWALE DRAIN
- EXISTING SURFACE LEVEL
- FINISHED BUILDING LINE LEVEL
- FINISHED RIDGE LINE LEVEL
- TOP OF RETAINING WALL
- BOTTOM OF RETAINING WALL
- RIDGE LINE
- RETAINING WALL
- ZERO LOT LINES
- PAVEMENT TREATMENT
- STRUCTURAL FILL > 200mm DEEP
- EX. STRUCTURAL FILL > 200mm DEEP
- DIRECTION OF FALL
- OVERLAND FLOW
- STRUCTURAL EARTHWORKS REQUIRED AND ALLOTMENT TO BE GRADED EVENLY IN DIRECTION OF FALL TO LEVELS INDICATED
- CONCRETE EDGE STRIP WITH SUBSOIL DRAIN, "NO ROAD" SIGN & BARRIER
- LIMIT OF WORKS
- EXISTING TREE TO BE REMOVED
- PERMANENT SURVEY MARK
- TEMPORARY BENCH MARK
- PROPOSED DRIVEWAY
- TREE PROTECTION ZONE (TPZ)

- NOTES:**
1. These plans are preliminary only and have not been approved by Council. They are subject to change without notice and have been provided as a guide only.
 2. This plan must be read in conjunction with the plan of subdivision. If any discrepancies are identified between the two plans, the plan of subdivision takes precedence.
 3. Proposed services and connection points shown are preliminary only and subject to authority advice and approval. Vehicle crossing locations shown are subject to Council approval.
 4. Existing surface levels refer to the existing surface surveyed by Beveridge Williams & Co Pty Ltd.
 5. Finished surface levels shown are preliminary only and may be subject to change during design and/or construction.
 6. The depth of fill can be determined by calculating the depth between the existing and proposed finished surface levels.
 7. Fill depths do not take into account any removal of topsoil, grubbing, or excavation associated with the construction of any temporary or permanent infrastructure within the subdivision.
 8. The plan shows the indicative extent of fill greater than 200mm in depth. These extents may be subject to change during design and/or construction. Fill less than 200mm in depth is not shown on this plan.
 9. The fill depth shown on this plan is for fill placed during construction of the subdivision whilst the site is under the control of Beveridge Williams & Co Pty Ltd. Beveridge Williams & Co Pty Ltd has no further knowledge or records of any other filling works throughout this subdivision, including prior to the survey being undertaken, or after the completion of construction.
 10. Beveridge Williams & Co Pty Ltd will not be liable for any loss or damages incurred or suffered by any party due to the use of the plans or relying on the information contained within these plans.

WARNING
BWARE OF UNDERGROUND SERVICES
 The locations of underground services are approximate only and their exact position should be proven on site.
 No guarantee is given that all existing services are shown.
 Locate all underground services before commencement of works
DIAL 1100 BEFORE YOU DIG
 www.1100.com.au

PRELIMINARY PRINT
NOT FOR CONSTRUCTION

© COPYRIGHT All rights reserved Beveridge Williams & Co. Pty Ltd has granted a licence to the principle to use this document for its intended purpose. No unauthorised copying is permitted.					
PS	LEGEND - LAYOUT PLAN NOTES REVISED	07.09.21	N.T.	S.K.	
P4	LOT 222 DRIVEWAY MOVED TO THE EAST BL	23.06.21	S.K.	S.K.	
P3	SEWER LAYOUT AND EASEMENTS AMENDED	29.04.21	S.G.	S.K.	
P2	FS & FR LEVEL CHANGES	20.10.20	S.G.	S.K.	
P1	ISSUED FOR INFORMATION	21.09.20	M.F.J.	S.K.	
REV	DESCRIPTION	DATE	DRN.	APP.	REV

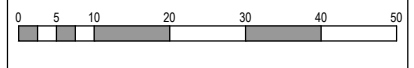

Designed Date: C. YAP 21.09.20
 Drawn: M.F. JAURIGUE
 Approved Date: S. KONG 21.09.20
 PS Number: -

BW Beveridge Williams
 1 Glenferrie Road
 Malvern VIC 3144
 ph: 03 9524 8888
 www.beveridgewilliams.com.au

Project Details FIVE FARMS STAGE 2 CITY OF CASEY	Sheet 02 of 02
Drawing Title SALES PLAN (SHEET 2 OF 2)	Scale 1:500 @ A1
Project Ref 1702037	Stage No 02
Drawing No 991	Rev P5