

LEGEND

W	PROPOSED WATER MAIN	ExW	Ex. WATER MAIN
NDW	NON-DRINKING WATER MAIN	ExNDW	Ex. NON-DRINKING WATER MAIN
G	PROPOSED GAS MAINS	ExG	Ex. GAS MAINS & VALVE
E	PROP. ELECTRICAL CABLES	ExE	Ex. ELECTRICAL CABLE
C	PROPOSED COMMS CABLES	ExC	Ex. COMMS CABLES
	PROPOSED DRAIN & PIT	ExD	Ex. DRAIN & PIT
	PROPOSED HOUSE DRAIN		Ex. HOUSE DRAIN
	PROPOSED PROPERTY INLET		Ex. TOE OF BATTER
	PROPOSED OUTFALL DRAIN		Ex. TOP OF BATTER
	PROPOSED TOE OF BATTER		Ex. CONTOUR MINOR
	PROPOSED TOP OF BATTER		Ex. FENCE
	PROP. CONTOUR MINOR		Ex. TACTILES
	DIRECTIONAL WARNING TACTILES		Ex. TACTILES REMOVE
	Ex. TREES		Ex. TREES REMOVE
	PSM		TBM
	Fb131.72		FINISHED TOP BATTER LEVEL
	F131.72		FINISHED SURFACE LEVEL
	E135.75		EXISTING SURFACE LEVEL
	49.50		FINISHED SURFACE CONTOURS (0.20m INT.)
	49.00		

THIS PLAN SHOWS APPROXIMATE EXTENTS OF CUT AND FILL TO BE UNDERTAKEN DURING CONSTRUCTION OF THE WORKS BASED ON THE EXISTING SITE SURFACE LEVELS AND PROPOSED FINISHED DESIGN LEVELS SHOWN. THE EXTENT OF FILL SHOWN IS BASED ON DESIGN AND MAY BE SUBJECT TO CHANGE DURING CONSTRUCTION. THE DEPTH OF TOP DRESSING FILL MAY VARY BY UP TO 0.15m.

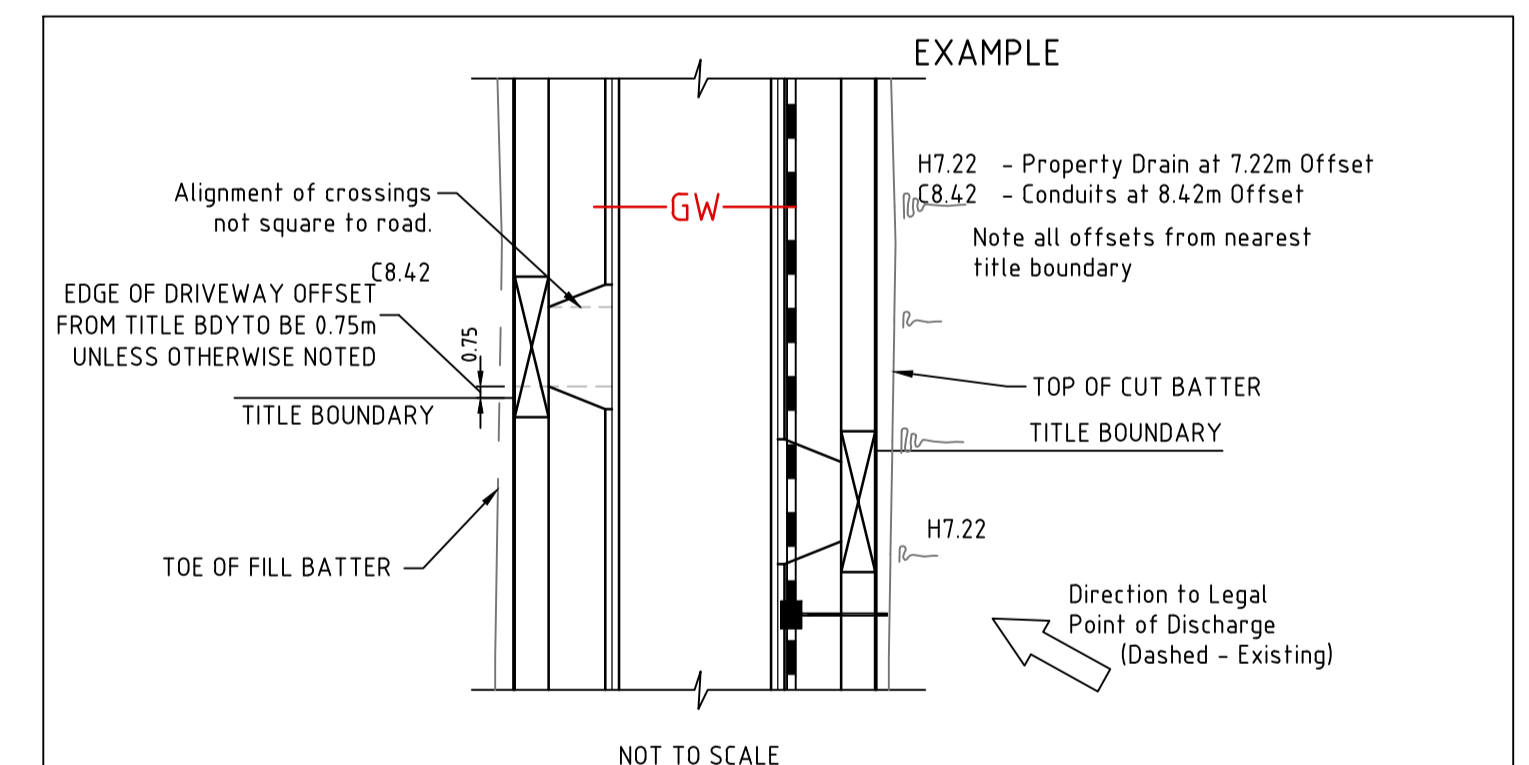
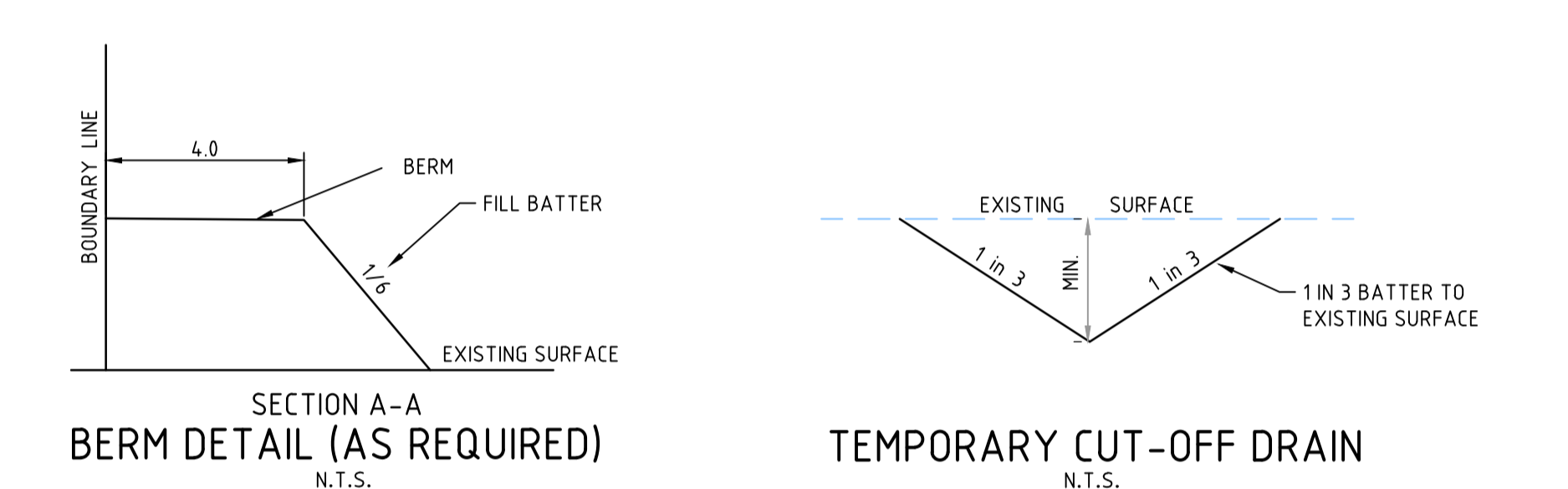

WARNING
BEWARE OF UNDERGROUND SERVICES
The locations of underground services are approximate only and their exact position should be proven on site prior to commencing works. No guarantee is given that all existing services are shown.

CONSTRUCTION ISSUE

H:\20569\PHASE 2\STAGE 22 & SCHOOL SITE\CAD\DWG SET\ROAD AND DRAINAGE\20569_22R2-4 & 40-53 (LAYOUTS & INT DETAILS).DWG

VERSION	REMARKS	DATE	BY
H	CONSTRUCTION ISSUE	02.11.22	NJR
G	PLAN UPDATED TO COUNCIL COMMENTS	10.10.22	DJK
F	COUNCIL COMMENTS	01.09.22	DJK
E	ISSUE TO COUNCIL	20.05.22	JB
D	DRIVEWAYS & PATH CROSSING UPDATED	15.02.22	DJK

DETAIL PLAN -1
SCALE

Scale 1:500 @ A1

DRAWN BY	D. KONSTANDIS	DESIGNED BY	J. BOSCO
MELWAY	665, C4	CHECKED BY	J. BOSCO
DATUM	AHD	AUTHORISED BY	H. DAY

REEDS CONSULTING

LAND SURVEYING
CIVIL ENGINEERING
PLANNING
LANDSCAPE ARCHITECTURE
DEVELOPMENT CONSULTING

www.reedsconsulting.com.au
engineering@reedsconsulting.com.au

Lvl 6, 440 Elizabeth Street Melbourne Victoria 3000
p 031 8660 3000

Copyright © Reeds Consulting Pty Ltd
All Rights Reserved 2001

MITCHELL SHIRE COUNCIL WALLARA WATERS ESTATE STAGE 22 & SCHOOL SITE LAYOUT PLAN 1		DRAWING No. 22R2	VERSION H
		REFERENCE 20569E/22	
		SHEET 2	OF 72

LEGEND

W	PROPOSED WATER MAIN	ExW	Ex. WATER MAIN
NDW	NON-DRINKING WATER MAIN	ExNDW	Ex. NON-DRINKING WATER MAIN
G	PROPOSED GAS MAINS	ExG	Ex. GAS MAINS & VALVE
E	PROP. ELECTRICAL CABLES	ExE	Ex. ELECTRICAL CABLE
C	PROPOSED COMMS CABLES	ExC	Ex. COMMS CABLES
	PROPOSED DRAIN & PIT	ExD	Ex. DRAIN & PIT
	PROPOSED HOUSE DRAIN		Ex. HOUSE DRAIN
	PROPOSED PROPERTY INLET		Ex. PROPERTY INLET
	PROPOSED OUTFALL DRAIN		Ex. TOE OF BATTER
	PROPOSED TOE OF BATTER		Ex. TOP OF BATTER
	PROPOSED TOP OF BATTER		Ex. CONTOUR MINOR
	PROP. CONTOUR MINOR		Ex. FENCE
	DIRECTIONAL WARNING TACTILES		Ex. TACTILES
	Ex. TREES		Ex. TREES REMOVE
	PSM		TBM
	Fb131.72		FINISHED TOP BATTER LEVEL
	E135.75		EXISTING SURFACE LEVEL
	4.8.50		FINISHED SURFACE CONTOURS (0.20m INT.)
	4.9.00		

THIS PLAN SHOWS APPROXIMATE EXTENTS OF CUT AND FILL TO BE UNDERTAKEN DURING CONSTRUCTION OF THE WORKS BASED ON THE EXISTING SITE SURFACE LEVELS AND PROPOSED FINISHED DESIGN LEVELS SHOWN. THE EXTENT OF FILL SHOWN IS BASED ON DESIGN AND MAY BE SUBJECT TO CHANGE DURING CONSTRUCTION. THE DEPTH OF TOP DRESSING FILL MAY VARY BY UP TO 0.15m.

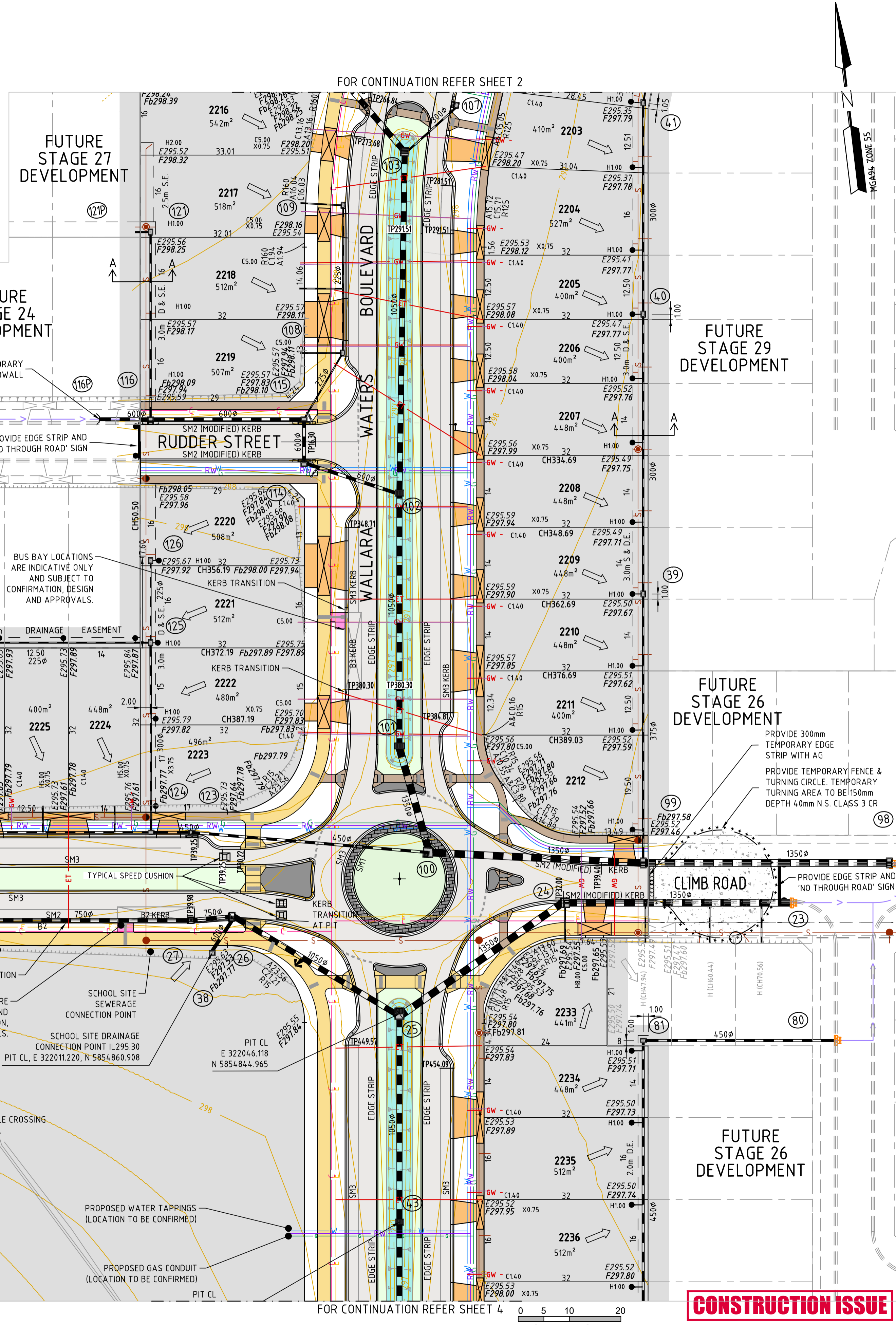
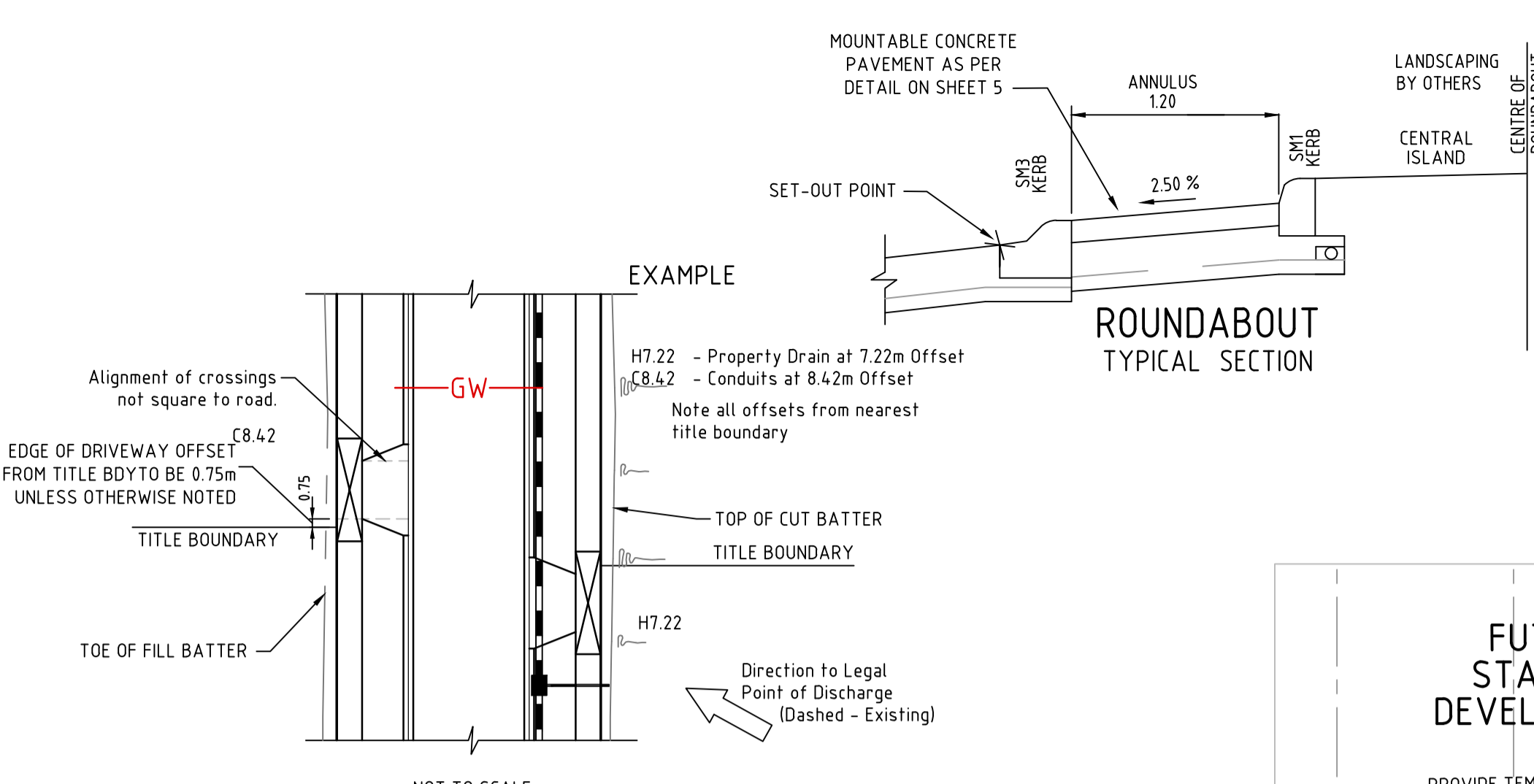

H:\20569\PHASE 2\STAGE 22 & SCHOOL SITE\CAD\DWG SET\ROAD AND DRAINAGE\20569_22R2-4 & 40-53 LAYOUTS & INT DETAILS\DWG

THIS DRAWING IS NOT TO BE COPIED OR SCALED

VERSION	REMARKS	DATE	BY
K	WING PLACE DRIVEWAYS SLIGHTLY RELOCATED TO ALIGN WITH FUTURE LOTS	07.02.23	NJR
J	CONSTRUCTION ISSUE	02.11.22	NJR
H	PLAN UPDATED TO COUNCIL COMMENTS	10.10.22	DJK
G	COUNCIL COMMENTS	01.09.22	DJK
F	FUTURE LOTS REVISED	20.06.22	JB

WARNING

BEWARE OF UNDERGROUND SERVICES

The locations of underground services are approximate only and their exact position should be proven on site prior to commencing works. No guarantee is given that all existing services are shown.

DETAIL PLAN -2

SCALE

0 5 10 20

Scale 1:500 @ A1

DRAWN BY	D. KONSTANDIS	DESIGNED BY	J. BOSCO
CHECKED BY	J. BOSCO	AUTHORISED BY	H. DAY
DATUM	AHD		

REEDS CONSULTING

LAND SURVEYING
CIVIL ENGINEERING
PLANNING
LANDSCAPE ARCHITECTURE
DEVELOPMENT CONSULTING

www.reedsconsulting.com.au | Lvl 6, 440 Elizabeth Street Melbourne Victoria 3000
engineering@reedsconsulting.com.au | p (03) 8660 3000

Copyright © Reeds Consulting Pty Ltd All Rights Reserved 2001

MITCHELL SHIRE COUNCIL
WALLARA WATERS ESTATE
STAGE 22 & SCHOOL SITE
LAYOUT PLAN 2

DRAWING No. 22R3
REFERENCE 20569E/22
SHEET 3 OF 72

VERSION K

CONSTRUCTION ISSUE

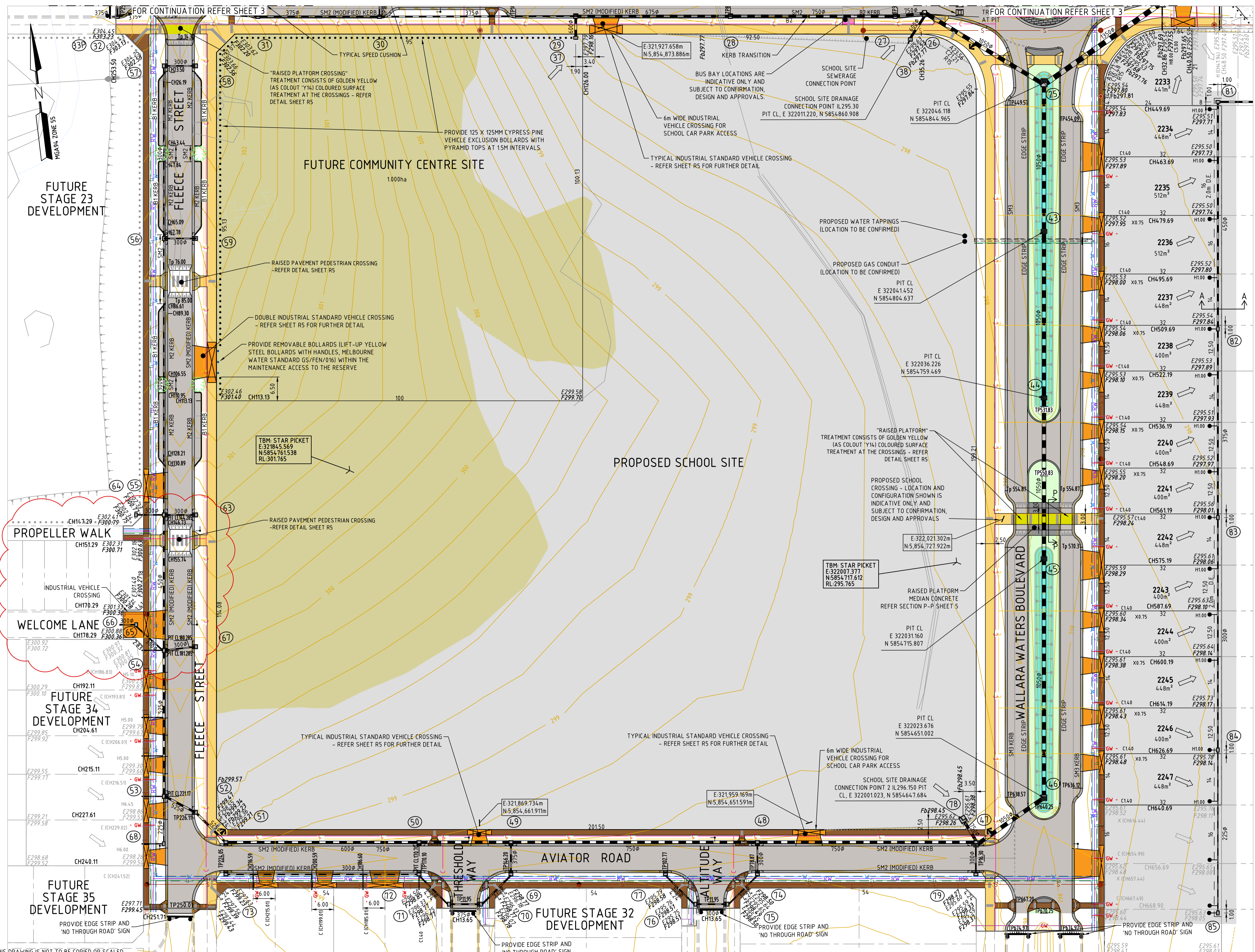

LEGEND

- W PROPOSED WATER MAIN
- NDW NON-DRINKING WATER MAIN
- G PROPOSED GAS MAINS
- E PROP. ELECTRICAL CABLES
- C PROPOSED COMMS CABLES
- PROPOSED DRAIN & PIT
- PROPOSED HOUSE DRAIN
- PROPOSED PROPERTY INLET
- PROPOSED OUTFALL DRAIN
- PROPOSED TOE OF BATTER
- PROPOSED TOP OF BATTER
- PROP. CONTOUR MINOR
- ExW Ex. WATER MAIN
- ExNDW Ex. NON-DRINKING WATER MAIN
- ExG Ex. GAS MAINS & VALVE
- ExE Ex. ELECTRICAL CABLE
- ExC Ex. COMMS CABLES
- Ex.D Ex. DRAIN & PIT
- Ex. HOUSE DRAIN
- Ex. TOE OF BATTER
- Ex. TOP OF BATTER
- Ex. CONTOUR MINOR
- Ex. FENCE
- DIRECTIONAL WARNING TACTILES
- Ex. TREES ↑ PSM
- FILL IN EXCESS OF 200mm
- CUT IN EXCESS OF 200mm
- Ex. TACTILES
- Ex. TREES REMOVE
- TBM Fb131.72 FINISHED TOP BATTER LEVEL
- Fb131.72 FINISHED SURFACE LEVEL
- E135.75 EXISTING SURFACE LEVEL
- 4.9.00 FINISHED SURFACE CONTOURS (0.20m INT.)

THIS PLAN SHOWS APPROXIMATE EXTENTS OF CUT AND FILL TO BE UNDERTAKEN DURING CONSTRUCTION OF THE WORKS BASED ON THE EXISTING SITE SURFACE LEVELS AND PROPOSED FINISHED DESIGN LEVELS SHOWN. THE EXTENT OF FILL SHOWN IS BASED ON DESIGN AND MAY BE SUBJECT TO CHANGE DURING CONSTRUCTION. THE DEPTH OF TOP DRESSING FILL MAY VARY BY UP TO 0.15m.

WARNING
BEWARE OF UNDERGROUND SERVICES
The locations of underground services are approximate only and their exact position should be proven on site prior to commencing works. No guarantee is given that all existing services are shown.

CONSTRUCTION ISSUE

H:\20569\PHASE 2\STAGE 22 & SCHOOL SITE\CAD\DWG SET\ROAD AND DRAINAGE\20569_22R2-4 & 40-53 (LAYOUTS & INT DETAILS).DWG

THIS DRAWING IS NOT TO BE COPIED OR SCALED

VERSION	REMARKS	DATE	BY
J	WELCOME LANE & PROPELLER WALK ROAD NAMES CHANGED, & SERVICES ADDED.	03.04.23	NJR
G	CONSTRUCTION ISSUE	02.11.22	NJR
H	PLAN UPDATED TO COUNCIL COMMENTS	10.10.22	DJK
F	COUNCIL COMMENTS	01.09.22	DJK
E	ISSUE TO COUNCIL	20.05.22	JB

DETAIL PLAN -4
SCALE
0 5 10 20
Scale 1:500 @ A1

DRAWN BY	D. KONSTANDIS	DESIGNED BY	J. BOSCO
CHECKED BY	MELWAY	665, C4	J. BOSCO
AUTHORISED BY	DATUM	AHD	H. DAY

REEDS CONSULTING
www.reedsconsulting.com.au
engineering@reedsconsulting.com.au

LAND SURVEYING
CIVIL ENGINEERING
PLANNING
LANDSCAPE ARCHITECTURE
DEVELOPMENT CONSULTING

Lvl 6, 440 Elizabeth Street Melbourne Victoria 3000
p 031 8660 3000

MITCHELL SHIRE COUNCIL
WALLARA WATERS ESTATE
STAGE 22 & SCHOOL SITE
LAYOUT PLAN 3

DRAWING No.	22R4	VERSION	J
REFERENCE	20569E/22		
SHEET	4 OF 72		