

LEGEND

- TREES TO BE RETAINED
- TREES TO BE REMOVED
- FILL IN EXCESS OF 200mm
- CUT IN EXCESS OF 200mm

THIS PLAN SHOWS APPROXIMATE EXTENTS OF CUT AND FILL TO BE UNDERTAKEN DURING CONSTRUCTION OF THE WORKS BASED ON THE EXISTING SITE SURFACE LEVELS AND PROPOSED FINISHED DESIGN LEVELS SHOWN.

THE EXTENT OF FILL SHOWN IS BASED ON DESIGN AND MAY BE SUBJECT TO CHANGE DURING CONSTRUCTION.

THE DEPTH OF TOP DRESSING FILL MAY VARY BY UP TO 0.15m.

EXAMPLE

Alignment of crossings not square to road.

TOP OF CUT BATTER

TOE OF FILL BATTER

Direction to Legal Point of Discharge (Dashed - Existing)

NOT TO SCALE

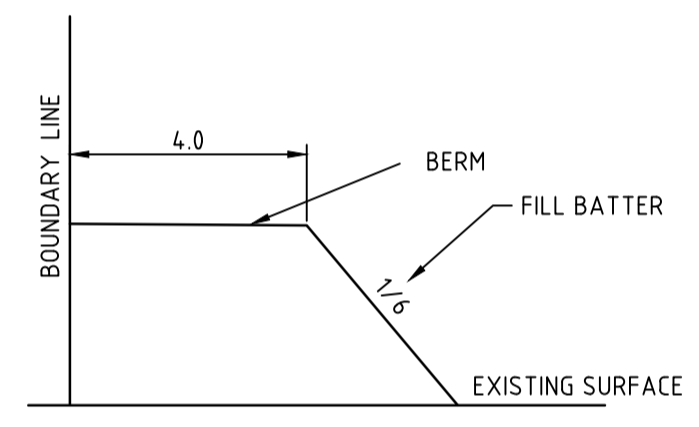
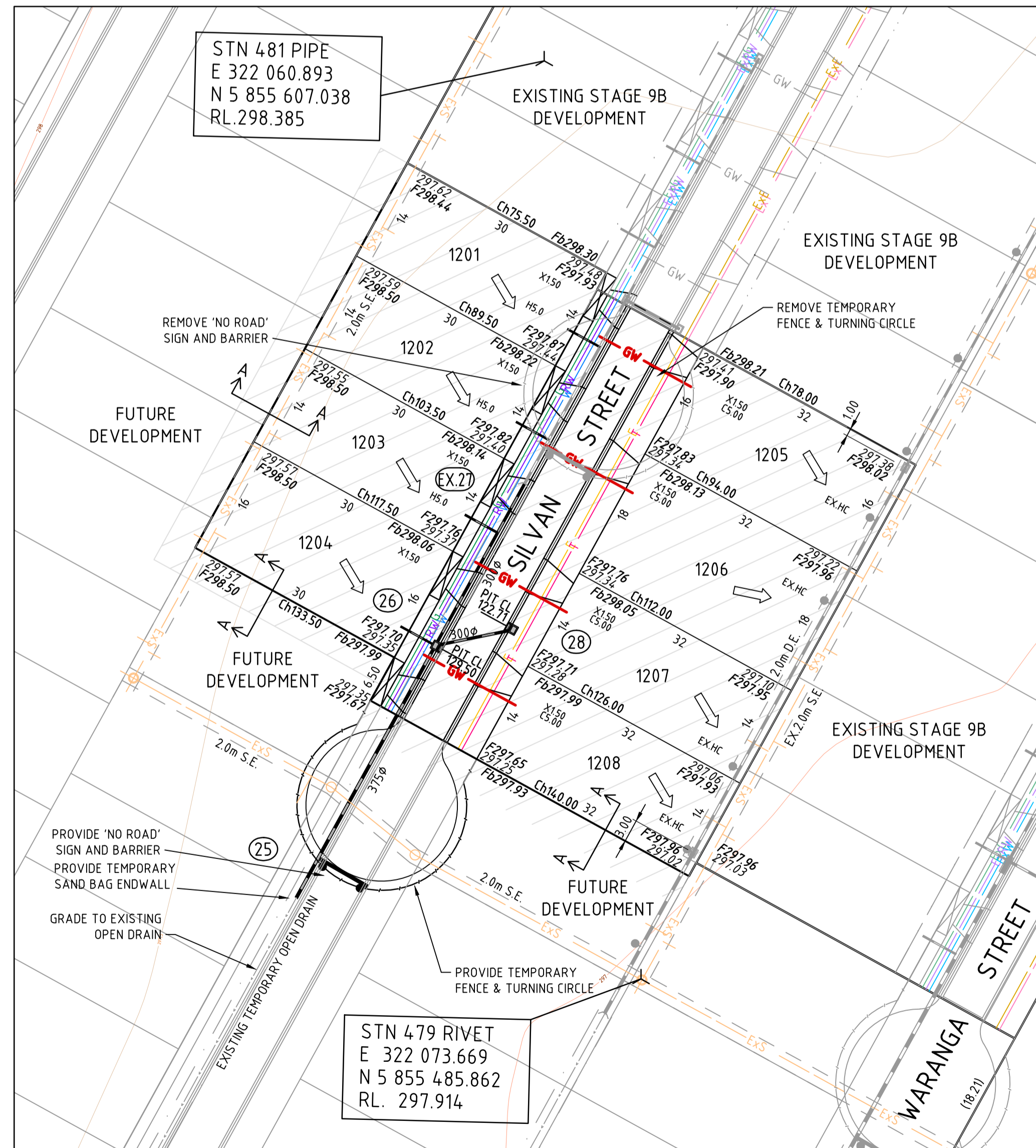

SECTION A-A BERM DETAIL (AS REQUIRED) N.T.S.

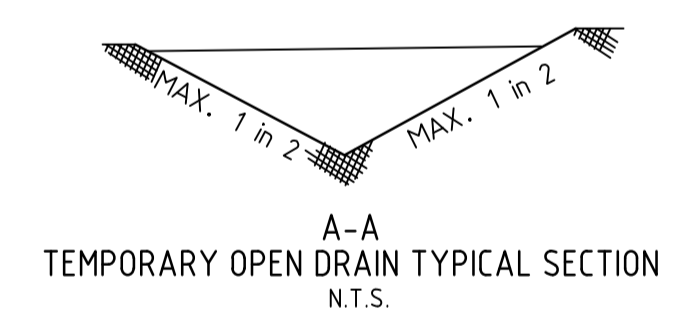

A-A TEMPORARY OPEN DRAIN TYPICAL SECTION N.T.S.

WARNING

BEWARE OF UNDERGROUND SERVICES

THE LOCATIONS OF UNDERGROUND SERVICES ARE APPROXIMATE ONLY AND THEIR EXACT POSITION SHOULD BE PROVEN ON SITE. NO GUARANTEE IS GIVEN THAT ALL EXISTING SERVICES ARE SHOWN.

Scale 1:500 @ A1

CONSTRUCTION PLAN

THIS DRAWING IS NOT TO BE COPIED OR SCALED

VERSION	REMARKS	DATE	BY
C	CONSTRUCTION ISSUE	28.06.17	NJR
B	LOT 1230 AND 1231 LOT BOUNDARY AMENDED	21.03.17	NJR
A	PRELIMINARY ISSUE	10.02.17	NJR

LEGEND

—	DRAIN, PROPERTY INLET & PIT	—	RECYCLED WATER
—	EX DRAIN & PIT	—	EX RECYCLED WATER
—	HOUSE DRAIN	—	EX ELECTRICAL U.G. SERVICES
—	SEWER AND MAINTENANCE HOLE	—	EX ELECTRICAL SERVICE & PIT
—	EX SEWER AND MAINTENANCE HOLE	—	EX ELECTRICAL ASSETS
—	WATER MAIN	—	EX ELECTRICAL OVERHEADS
—	EX WATER MAIN, VALVE & HYDRANT	—	GAS & WATER CONDUITS
—	GAS MAIN	—	TOP OF BATTER
—	EX GAS MAIN, VALVE	—	TOE OF BATTER
—	TELSTRA SERVICES & PITS	—	EX FENCE
—	EX TELSTRA SERVICES & PITS	—	EX WALL OR BUILDING

DRAWN BY	N. ROBINSON	DESIGNED BY	J. BOSCO
MELWAY	646, E12	CHECKED BY	J. MCKERNAN
DATUM	AHD	AUTHORISED BY	R. RAVIDA

REEDS CONSULTING

LAND SURVEYING
CIVIL ENGINEERING
PLANNING
DEVELOPMENT CONSULTING

www.reedsconsulting.com.au
engineering@reedsconsulting.com.au

Lvl 6, 440 Elizabeth Street Melbourne Victoria 3000
p (03) 8640 3000

MITCHELL SHIRE COUNCIL		DRAWING No.	VERSION
WALLARA WATERS ESTATE		12R2	C
STAGE 12 LAYOUT PLAN		REFERENCE	
		20569E/12	
		SHEET	2 OF 11