



	Reeds Consulting Pty Ltd Lvl 6, 440 Elizabeth Street Melbourne Victoria 3000 p. (03) 8660 3000 www.reedsconsulting.com.au survey@reedsconsulting.com.au	SCALE LENGTHS ARE IN METRES	ORIGINAL SCALE 1:750	SHEET SIZE A4	SHEET 1 REF: 20569/14MCP VERSION: E 14MCP-E.DGN DATE: 25/08/2020
	<p>1. THE BUILDING ENVELOPES AND GARAGE ENVELOPES ON THIS PLAN ARE SHOWN ENCLOSED BY THICK CONTINUOUS LINES.</p> <p>2. THIS DIAGRAM IS TO BE READ IN CONJUNCTION WITH THE MEMORANDUM OF COMMON PROVISIONS.</p> <p>3. THE BUILDING CAN BE BUILT ON EITHER SIDE BOUNDARY WHERE NOTED AS "0 or 1" ON THIS DIAGRAM BUT MUST MAINTAIN A MINIMUM 1m SET BACK ON THE OPPOSITE BOUNDARY.</p>				

LEGEND

BUILDING ENVELOPE
 GARAGE ENVELOPE

1433

SEE SHEET 3

1432

1431

1403

STAG PLACE

SIM STREET

1417

SEE SHEET 2

1416

STAG

STAG PLACE

SAMSON BROOK DRIVE

YAN YEAN AVENUE

MGA94 ZONE 55

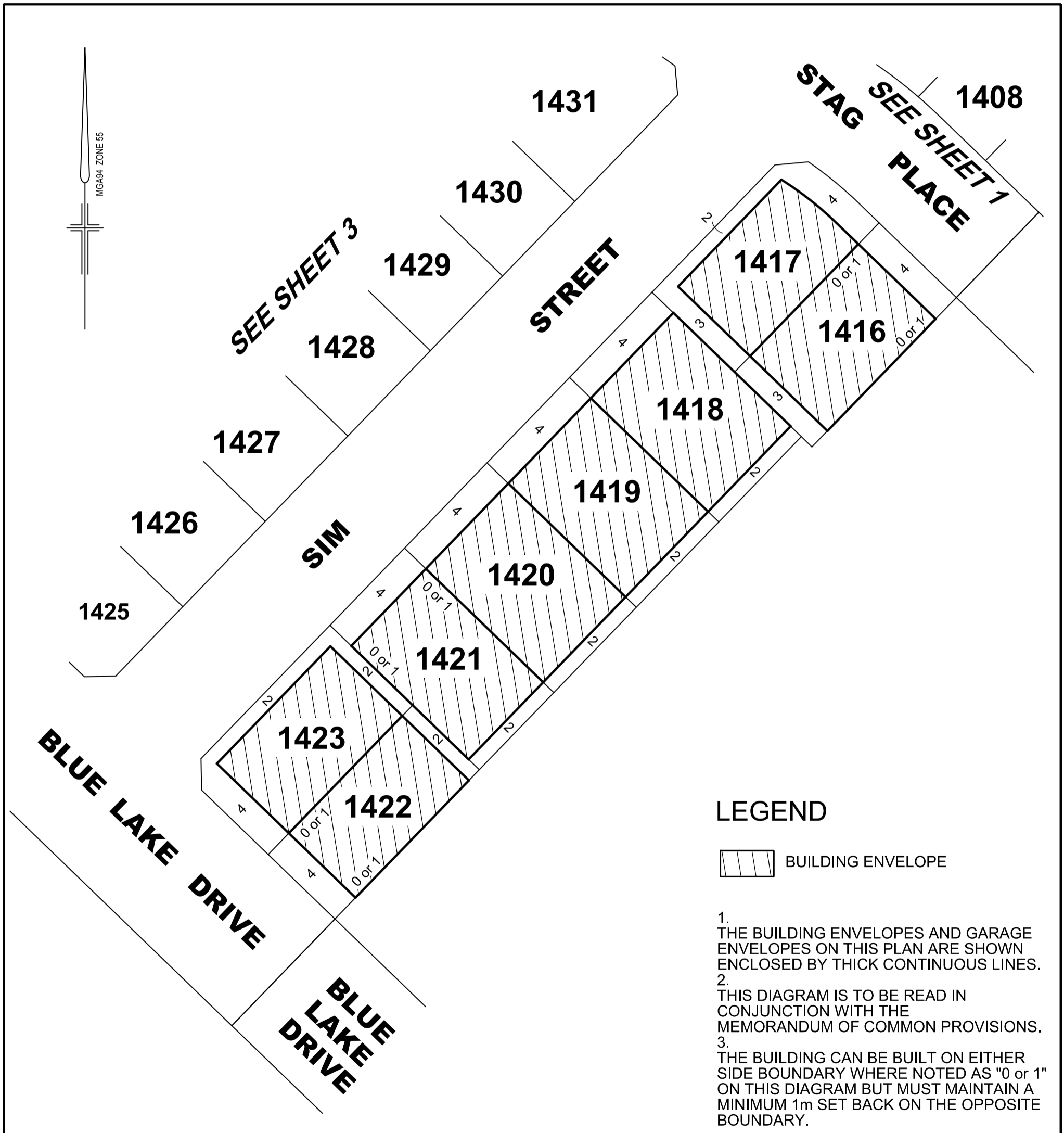
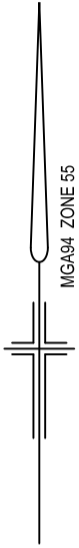

LEGEND

 BUILDING ENVELOPE

1. THE BUILDING ENVELOPES AND GARAGE ENVELOPES ON THIS PLAN ARE SHOWN ENCLOSED BY THICK CONTINUOUS LINES.
2. THIS DIAGRAM IS TO BE READ IN CONJUNCTION WITH THE MEMORANDUM OF COMMON PROVISIONS.
3. THE BUILDING CAN BE BUILT ON EITHER SIDE BOUNDARY WHERE NOTED AS "0 or 1" ON THIS DIAGRAM BUT MUST MAINTAIN A MINIMUM 1m SET BACK ON THE OPPOSITE BOUNDARY.



Reeds Consulting Pty Ltd
 Lvl 6, 440 Elizabeth Street
 Melbourne Victoria 3000
 p (03) 8660 3000
 www.reedsconsulting.com.au
 survey@reedsconsulting.com.au

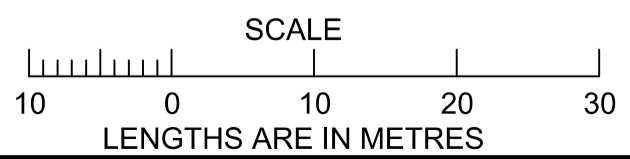

ORIGINAL
 SCALE SHEET
 1:750 SIZE
 A4

SHEET 2
 REF: **20569/14MCP**
 VERSION: **E** 14MCP-E.DGN
 DATE: 25/08/2020

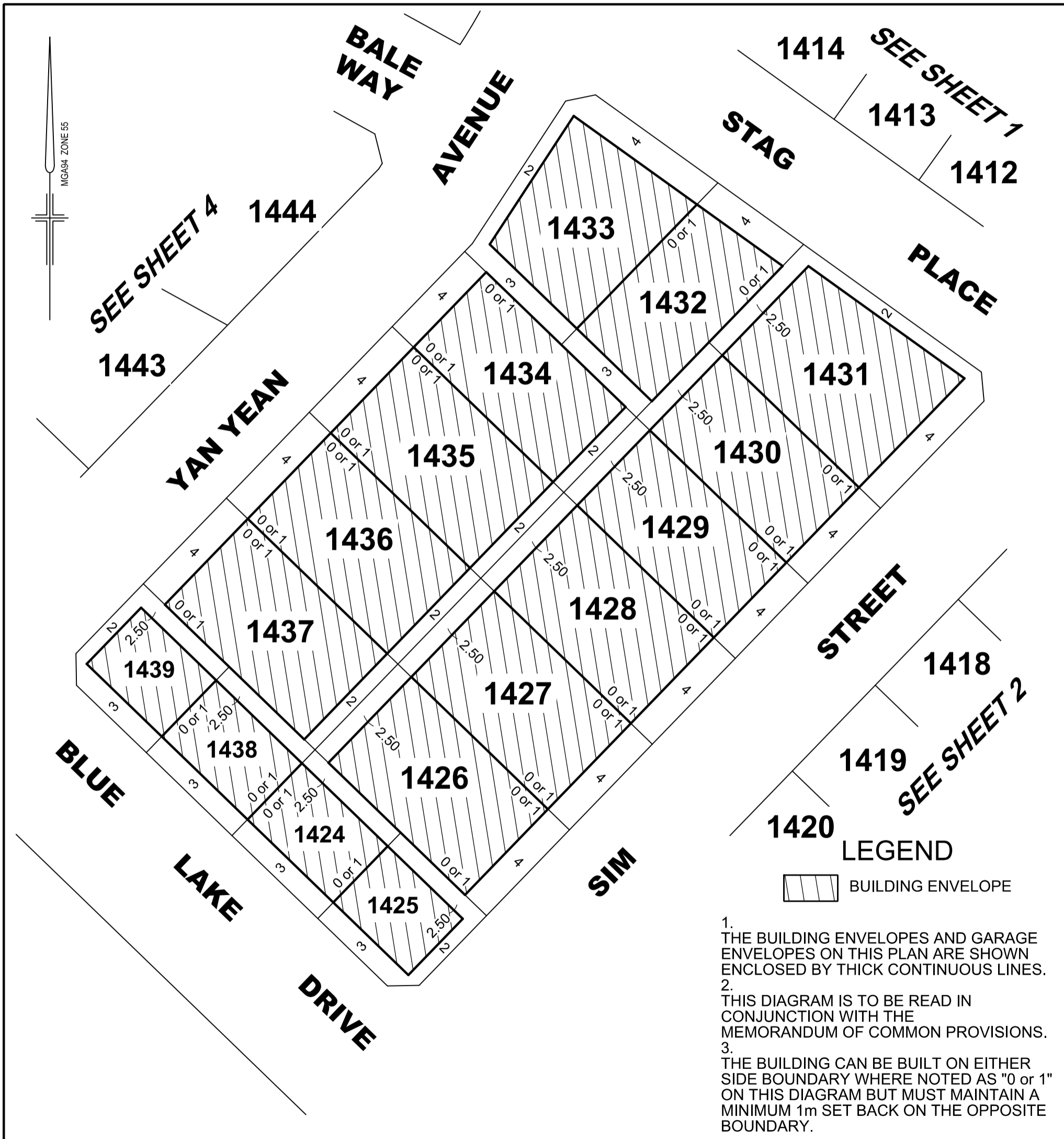

1414 SEE SHEET 1
1413
1412

SEE SHEET 4
1444
1443

1418
1419 SEE SHEET 2
1420

LEGEND
 BUILDING ENVELOPE

1. THE BUILDING ENVELOPES AND GARAGE ENVELOPES ON THIS PLAN ARE SHOWN ENCLOSED BY THICK CONTINUOUS LINES.
2. THIS DIAGRAM IS TO BE READ IN CONJUNCTION WITH THE MEMORANDUM OF COMMON PROVISIONS.
3. THE BUILDING CAN BE BUILT ON EITHER SIDE BOUNDARY WHERE NOTED AS "0 or 1" ON THIS DIAGRAM BUT MUST MAINTAIN A MINIMUM 1m SET BACK ON THE OPPOSITE BOUNDARY.

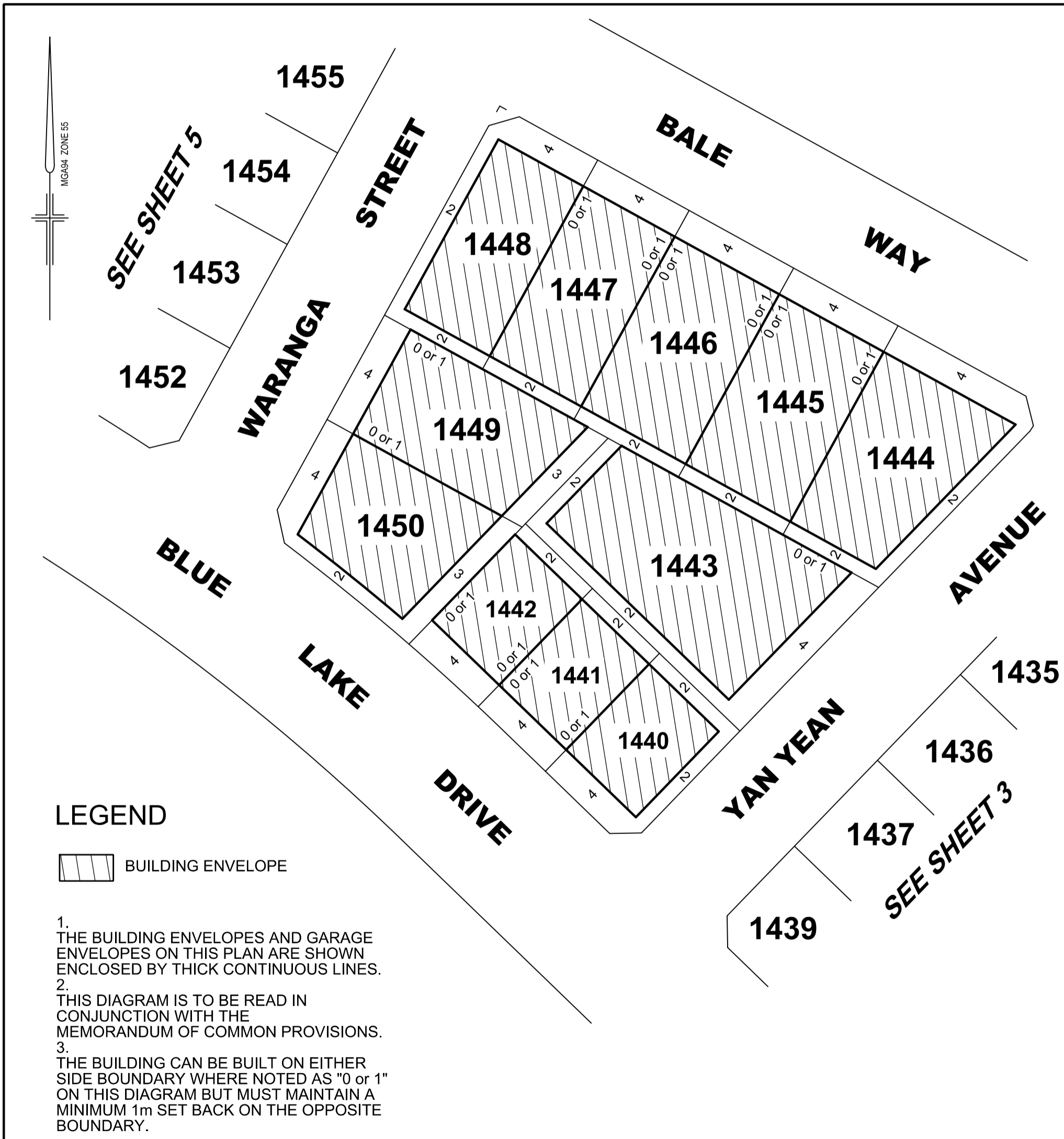

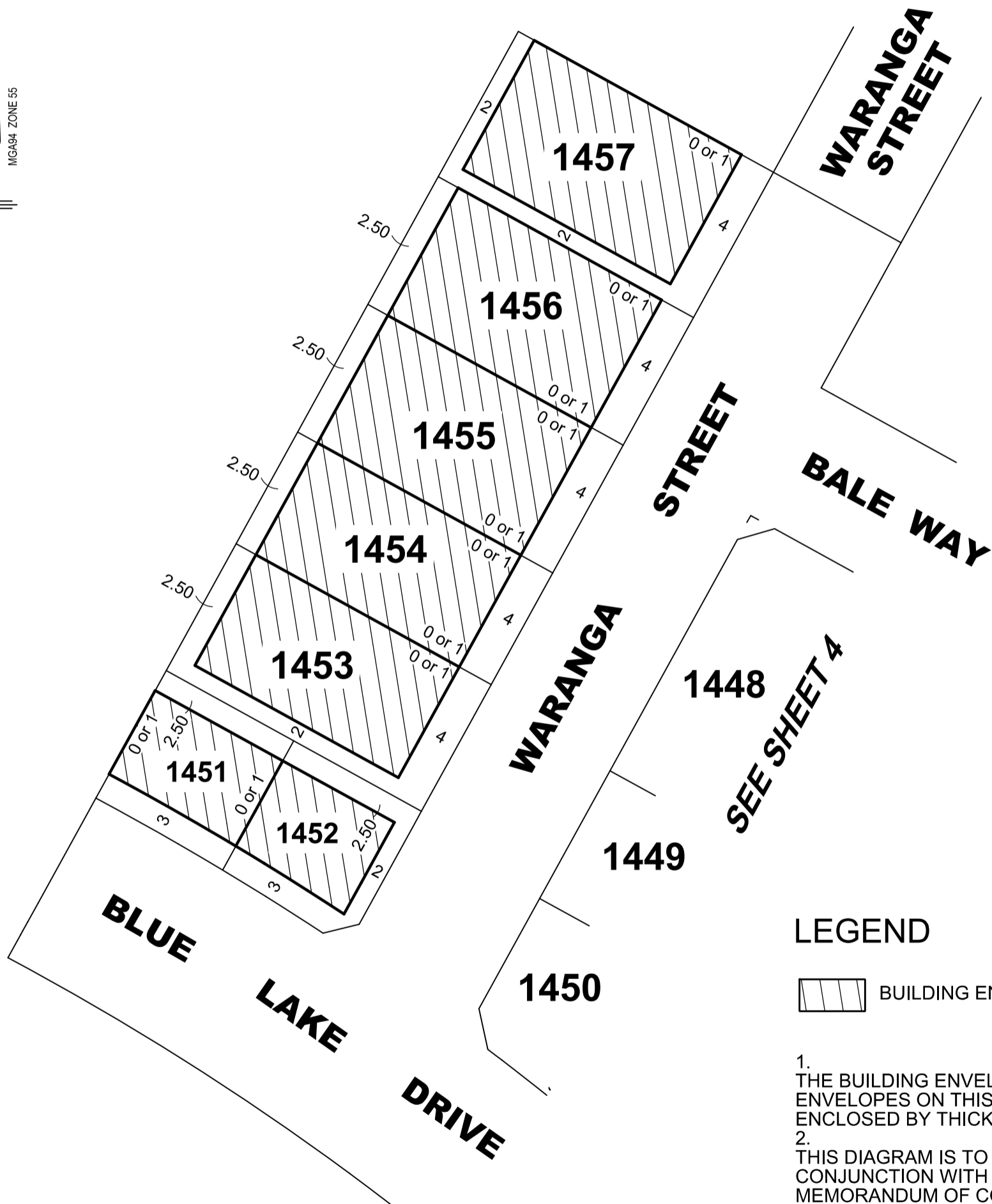
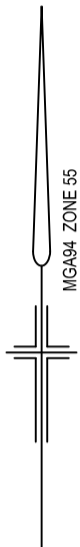

LEGEND

 BUILDING ENVELOPE

1. THE BUILDING ENVELOPES AND GARAGE ENVELOPES ON THIS PLAN ARE SHOWN ENCLOSED BY THICK CONTINUOUS LINES.
2. THIS DIAGRAM IS TO BE READ IN CONJUNCTION WITH THE MEMORANDUM OF COMMON PROVISIONS.
3. THE BUILDING CAN BE BUILT ON EITHER SIDE BOUNDARY WHERE NOTED AS "0 or 1" ON THIS DIAGRAM BUT MUST MAINTAIN A MINIMUM 1m SET BACK ON THE OPPOSITE BOUNDARY.