

STN 3 PIPE  
E 322 040.852  
N 5 856 146.965  
RL

EXISTING DRAIN WITHIN LOT 1124 TO BE REMOVED AND EXISTING TRENCH TO BE STRIPPED TO FIRM BASE AND FILL.

- IN LOTS WITH SITE MATERIAL COMPACTED TO 95% S.C.T.D.
- IN ROAD RESERVE FILLED WITH NDOR OR APPROVED SELECTED IMPORTED MATERIAL COMPACTED TO MIN. 98% S.C.T.D.

ALL FILL TESTING AND COMPACTION TO BE UNDERTAKEN UNDER LEVEL 1 CONTROL & SUPERVISION

PROVIDE NO ROAD SIGN & BARRIER

THIS DRAWING IS NOT TO BE COPIED OR SCALED

**LEGEND**

- TREES TO BE RETAINED
- TREES TO BE REMOVED
- FILL IN EXCESS OF 200mm
- CUT IN EXCESS OF 200mm

THIS PLAN SHOWS APPROXIMATE EXTENTS OF CUT AND FILL TO BE UNDERTAKEN DURING CONSTRUCTION OF THE WORKS BASED ON THE EXISTING SITE SURFACE LEVELS AND PROPOSED FINISHED DESIGN LEVELS SHOWN.

THE EXTENT OF FILL SHOWN IS BASED ON DESIGN AND MAY BE SUBJECT TO CHANGE DURING CONSTRUCTION.

THE DEPTH OF TOP DRESSING FILL MAY VARY BY UP TO 0.15m.

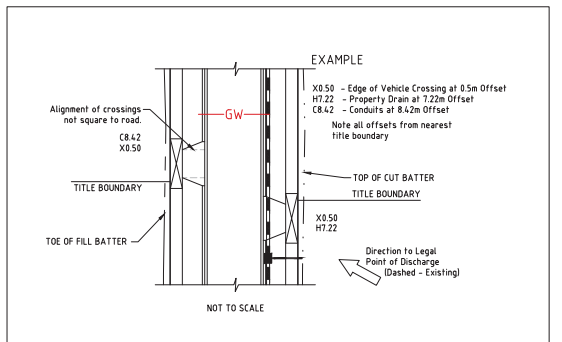

**WARNING**

BEWARE OF UNDERGROUND SERVICES

THE LOCATIONS OF UNDERGROUND SERVICES ARE APPROXIMATE ONLY AND THEIR EXACT POSITION SHOULD BE PROVEN ON SITE. NO GUARANTEE IS GIVEN THAT ALL EXISTING SERVICES ARE SHOWN.

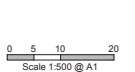

**PRELIMINARY PLAN ONLY**

NOT APPROVED FOR CONSTRUCTION

VERSION	REMARKS	DATE	BY	CHKD
B	STAGE LAYOUT REVISED	18.01.12	PC	
A	PRELIMINARY ISSUE	05.03.12	NJR	

LEGEND	
	DRAIN PROPERTY INLET & PIT
	RECYCLED WATER
	SEWER AND MAINTENANCE HOLE
	WATER MAIN
	EX GAS MAIN
	TELSTRA SERVICES & PITS
	EX TELSTRA SERVICES & PITS
	F FINISHED SURFACE AFTER CUTTING OR FILLING
	TOP OF PROPOSED BATTER
	PROPOSED PAVEMENT OR FOOTPATH SURFACE
	EXISTING OR PROPOSED INVERT LEVEL OF PIPE OR OPEN DRAIN
	TANGENT POINT
	CHANNAGE
	POLE
	STREET SIGN
	DRAINAGE PIT NO. 1TM
	EX FENCE
	EX WALL OR BUILDING

DRAWN BY	NJR	DESIGNED BY	JB
CHECKED BY	MELWAY	29.01.12	
AUTHORIZED BY	AHD		SR

**REEDS CONSULTING**

LAND SURVEYING  
CIVIL ENGINEERING  
PLANNING  
DEVELOPMENT CONSULTING

MITCHELL SHIRE COUNCIL  
WALLARA WATERS ESTATE  
STAGE 11  
LAYOUT PLAN

www.reedsconsulting.com.au  
Level 4, 401 Edgewood Street, Wallara, WA 6472  
Tel: 08 9432 3333

DRAWING No.	11R2	VERSION	B
REFERENCE	20569E/11		
SHEET	2 OF 13		